

TEXTON



**BASICS**  
WINDOW SHADINGS

Effective February 4, 2019

*design simplified™*

---

# TABLE OF CONTENTS

---

## Product Overview

- Features & Benefits ..... 3
- Collection Information (includes Light Control) ..... 4

## Pricing Groups

- Pricing Group 1 (Translucent) ..... 5
- Pricing Group 2 (Light Dimming) ..... 6

## Product Specifications

- Product Specifications and Finished Dimensions ..... 7
- Options and Additional Notes ..... 8
- Standard Shading Operation ..... 9
- Motorization Overview ..... 10-11
- Product Components ..... 12-14

### **Oversize Common Carrier Delivery**

All orders with any quantity of shades or blinds or any continuous valance 96" or more in width are considered oversize. Therefore, a net shipping charge of \$40 per oversized unit will be assessed.

Oversized orders that require expedited shipping will be quoted and charged accordingly.

Please see General Information for additional freight and shipping charge information.

## FEATURES & BENEFITS



- Offered in the popular 2-1/2" vane size, ideal for any size window.
- Streamlined collection featuring both translucent and light-dimming vane styles to provide varying degrees of light control.
- Available with one of the two new motorization systems
  - Simplicity Rechargeable: Rechargeable RF motorization system provides months of use between charges (with normal use). The rechargeable battery is hidden in the rotating rail meaning no external battery pack. Solar recharge option available.
  - PowerWand: The ease of Simplicity motorization with the convenience of remote free operation. Lift and lower the shading with the touch of a button on the pendant that hangs from the front of the headrail. The rechargeable battery is charged using the charging port in pendant.
    - > To suit your customer's needs the black or white colored wand is available in one foot increments from one to five feet and can be placed on either the left or right.
- Limited Lifetime Warranty ensures your customers' satisfaction.

# COLLECTION INFORMATION

Family Name	Color Name	Family Code	Color #	Coordinating Hardware Color Name	Light Control	Price Group
<b>Dynamic</b> 2-1/2" Translucent	Aspen	DYSS	335	White	B	1
	Confection	DYSS	333	White	B	1
	Mystic	DYSS	331	White	B	1
	Pencil Sketch	DYSS	330	White	B	1
	Poppyfield	DYSS	334	White	B	1
	Tailwind	DYSS	332	White	B	1
<b>Mistral</b> 2-1/2" Translucent	Bay Leaf	MTSS	300	Evening Light	B	1
	Casual White	MTSS	304	White	B	1
	December Gray	MTSS	305	Silver Gray	B	1
	Prailine	MTSS	303	Vanilla	B	1
	Sailcloth	MTSS	302	Vanilla	B	1
	Wildflower	MTSS	301	Vanilla	B	1
<b>Pergola</b> 2-1/2" Translucent	Butter Cream	PGSS	315	Vanilla	B	1
	Canvas	PGSS	313	Vanilla	B	1
	Cobblestone	PGSS	310	Silver Gray	B	1
	Cotton Field	PGSS	311	White	B	1
	Honey Beige	PGSS	314	Vanilla	B	1
	Spring Snow	PGSS	312	White	B	1
<b>Repose</b> 2-1/2" Light Dimming *	Cloud White	RPSS	325	White	C	2
	Peaceful	RPSS	322	Vanilla	C	2
	Sandrift	RPSS	323	Vanilla	C	2
	Sesame	RPSS	324	Vanilla	C	2
	Shadow	RPSS	320	Silver Gray	C	2
	Twilight	RPSS	321	White	C	2

\* Light Dimming fabrics provide category C, opaque light control because even when the vanes are completely closed they DO NOT completely seal off all incoming light.

See vane closure diagram on page 8 for a visual reference.

Note: Collections are presented alphabetically. Within each collection colors are also arranged alphabetically



**A. Glare Reducing**

Softly filters light and reduces glare. Images, shapes and people can be seen clearly. Provides the least amount of light and shape screening.



**B. Filtering**

Filters strong light. Images, shapes and people can be seen with some clarity. Provides a modest degree of light and shape screening.



**C. Shading**

Significantly reduces light. Images, shapes and people cannot be seen clearly. Provides a moderate to strong degree of light and shape screening.



**D. Blocking**

Dramatically reduces light. Images, shapes and people are not distinguishable. Provides privacy against most all direct light and shape screening (except minimal light that may seep through closed or overlapping opaque/blackout vanes).



**E. Blackout**

Blocks out virtually all light (except light that may enter on the sides of the shade) for maximum privacy and darkness.

**2-1/2" Translucent  
Dynamic (DYSS)  
Mistral (MTSS)  
Pergola (PGSS)**

**GROUP 1**

WIDTH TO:	24"	30"	36"	42"	48"	54"	60"	66"	72"	76"	84"	90"	96"	102"	109"	120"
HEIGHT TO:																
36"	\$575	648	719	792	861	939	1007	1081	1270	1345	1419	1494	1563	1661	1860	2031
42"	603	685	761	841	920	1001	1081	1161	1353	1437	1517	1599	1675	1782	1993	2177
48"	642	721	809	891	980	1065	1160	1247	1442	1529	1615	1700	1789	1896	2121	2315
54"	665	760	850	948	1041	1135	1231	1337	1528	1622	1714	1812	1912	2029	2276	2484
60"	699	801	898	994	1094	1208	1311	1421	1609	1716	1817	1929	2040	2177	2447	2673
66"	729	840	945	1048	1161	1275	1396	1513	1695	1814	1931	2054	2169	2321	2621	2861
72"	761	877	989	1103	1225	1353	1478	1602	1789	1913	2041	2169	2296	2457	2779	3033
78"	783	905	1026	1154	1277	1410	1540	1677	1873	2011	2143	2280	2406	2584	2923	3192
84"	815	945	1069	1209	1345	1483	1627	1768	1970	2118	2258	2397	2536	2721	3083	3366
90"	849	980	1117	1266	1410	1561	1707	1855	2065	2216	2370	2518	2665	2856	3238	3533
96"	882	1023	1163	1321	1478	1629	1785	1942	2161	2321	2481	2635	2793	3001	3400	3709
102"	1009	1169	1327	1501	1659	1810	2020	2219	2374	2534	2699	2852	3010	3201	3611	3944
108"	1060	1227	1396	1577	1743	1906	2123	2340	2497	2667	2840	3005	3170	3369	3805	4153
114"	1124	1304	1481	1677	1857	2025	2257	2482	2653	2836	3010	3185	3359	3574	4029	4401
120"	1209	1396	1590	1794	1981	2169	2415	2657	2840	3033	3227	3410	3599	3825	4313	4712

STANDARD FEATURES
<ul style="list-style-type: none"> <li>• Headrail Size: 3-5/8" x 3"</li> <li>• Snap-in Bracket Style</li> <li>• Cord Tilt &amp; Lift</li> <li>• Color-Coordinated Hardware</li> </ul>

OPTIONS: NO CHARGE – SPECIFY ON ORDER
<ul style="list-style-type: none"> <li>• Tilt Only</li> <li>• Control Positions (R or L)</li> <li>• Spacer Blocks</li> <li>• Hold-Down Brackets</li> <li>• Two-On-One Headrail – price as 2 separate shades (Standard Cord Loop Only)</li> </ul>

OPTIONS: EXTRA CHARGE
<ul style="list-style-type: none"> <li>• Fabric Headrail Insert . . . . . add \$66 per shading</li> <li>• Cordless Lift . . . . . add \$134 per shading</li> </ul>

MOTORIZATION OPTIONS: EXTRA CHARGE
<ul style="list-style-type: none"> <li>• Simplicity Rechargeable Motor . . . . . add \$489 per shading (Charging port available on the right side only) – 5 Channel Remote Control (Black Part #CS5138 or White Part #CS5138W) . . . . . add \$72 each – Solar Panel (Part #CS52096) . . . . . add \$267 each</li> <li>• PowerWand . . . . . add \$196 per shading – PowerWand Options (must be specified): 1) Control Side (Left or Right) 2) Wand Color (Black or White) 3) Wand Length: 1 foot (12") 2 feet (24") 3 feet (36") 4 feet (48") 5 feet (60")</li> <li>• Plug-in Charger (Can be used for both Simplicity Rechargeable and PowerWand) (Part #CS5199) . . . . . add \$54 each</li> </ul>

SIZE STANDARDS	Standard Cord Loop	
	Single Shade	2-on-1 Headrail
Minimum ordered width	12"	24"
Minimum ordered width – tilt only	6"	N/A
Maximum ordered width	120"	120"
Maximum ordered width – tilt only	11-7/8"	N/A
Minimum ordered height	16"	16"
Maximum ordered height – translucent	120"	120"

SIZE STANDARDS	Cordless Lift	Simplicity Rechargeable	PowerWand™
Minimum ordered width	18"	19"	21"
Minimum ordered width – tilt only	NA	N/A	N/A
Maximum ordered width	84"	120"	120"
Maximum ordered width – tilt only	NA	N/A	N/A
Minimum ordered height	16"	16"	16"
Maximum ordered height – translucent	84"	120"	120"

**2-1/2" Light Dimming  
Repose (RPSS)**

**GROUP 2**

WIDTH TO:	24"	30"	36"	42"	48"	54"	60"	66"	72"	76"	84"	90"	96"	102"	109"	120"
<b>HEIGHT TO:</b>																
36"	\$635	713	793	873	950	1033	1108	1192	1393	1480	1561	1645	1721	1828	2052	2239
42"	665	758	840	927	1016	1103	1192	1275	1492	1579	1670	1757	1844	1956	2185	2386
48"	703	793	891	980	1080	1174	1273	1369	1579	1679	1775	1871	1967	2086	2338	2552
54"	733	836	939	1042	1138	1247	1353	1465	1677	1785	1883	1995	2109	2233	2513	2744
60"	769	877	987	1096	1208	1323	1449	1563	1769	1883	2001	2123	2248	2392	2690	2937
66"	802	916	1041	1160	1275	1405	1535	1666	1865	1997	2127	2257	2385	2553	2884	3149
72"	840	962	1090	1211	1350	1492	1624	1759	1967	2109	2249	2385	2520	2703	3096	3378
78"	861	991	1129	1268	1405	1558	1697	1846	2061	2209	2361	2507	2649	2841	3321	3625
84"	898	1041	1174	1325	1481	1631	1791	1942	2169	2329	2482	2783	2907	3025	3561	3887
90"	936	1080	1225	1389	1556	1716	1880	2038	2265	2436	2738	2905	3032	3220	3737	4079
96"	1069	1225	1387	1561	1718	1873	2059	2246	2523	2681	2841	3003	3160	3378	3921	4281
102"	1225	1401	1579	1775	1928	2077	2331	2566	2770	2930	3094	3245	3405	3609	4164	4546

STANDARD FEATURES
<ul style="list-style-type: none"> <li>• Headrail Size: 3-5/8" x 3"</li> <li>• Snap-in Bracket Style</li> <li>• Cord Tilt &amp; Lift</li> <li>• Color-Coordinated Hardware</li> </ul>

OPTIONS: NO CHARGE – SPECIFY ON ORDER
<ul style="list-style-type: none"> <li>• Tilt Only</li> <li>• Control Positions (R or L)</li> <li>• Spacer Blocks</li> <li>• Hold-Down Brackets</li> <li>• Two-On-One Headrail – price as 2 separate shades (Standard Cord Loop Only)</li> </ul>

OPTIONS: EXTRA CHARGE
<ul style="list-style-type: none"> <li>• Fabric Headrail Insert . . . . . add \$66 per shading</li> <li>• Cordless Lift . . . . . add \$134 per shading</li> </ul>

MOTORIZATION OPTIONS: EXTRA CHARGE
<ul style="list-style-type: none"> <li>• Simplicity Rechargeable Motor . . . . . add \$489 per shading (Charging port available on the right side only)                             <ul style="list-style-type: none"> <li>– 5 Channel Remote Control (Black Part #CS5138 or White Part #CS5138W) . . . . . add \$72 each</li> <li>– Solar Panel (Part #CS52096) . . . . . add \$267 each</li> </ul> </li> <li>• PowerWand . . . . . add \$196 per shading                             <ul style="list-style-type: none"> <li>– PowerWand Options (must be specified):                                     <ol style="list-style-type: none"> <li>1) Control Side (Left or Right)</li> <li>2) Wand Color (Black or White)</li> <li>3) Wand Length:   <ul style="list-style-type: none"> <li>1 foot (12")</li> <li>2 feet (24")</li> <li>3 feet (36")</li> <li>4 feet (48")</li> <li>5 feet (60")</li> </ul> </li> </ol> </li> </ul> </li> <li>• Plug-in Charger (Can be used for both Simplicity Rechargeable and PowerWand) (Part #CS5199) . . . . . add \$54 each</li> </ul>

SIZE STANDARDS	Standard Cord Loop	
	Single Shade	2-on-1 Headrail
Minimum ordered width	12"	24"
Minimum ordered width – tilt only	6"	N/A
Maximum ordered width	120"	120"
Maximum ordered width – tilt only	11-7/8"	N/A
Minimum ordered height	16"	16"
Maximum ordered height – light dimming	102"	102"

SIZE STANDARDS	Cordless Lift	Simplicity Rechargeable	PowerWand™
Minimum ordered width	18"	19"	21"
Minimum ordered width – tilt only	N/A	N/A	N/A
Maximum ordered width	84"	120"	120"
Maximum ordered width – tilt only	N/A	N/A	N/A
Minimum ordered height	16"	16"	16"
Maximum ordered height – light dimming	84"	102"	102"

# PRODUCT SPECIFICATIONS

FEATURES	
# of fabric styles	4
# of colors	24
Headrail size	3-5/8" x 3"
Bracket style	Snap-in
Cord loop tilt and lift	Yes
Safety cord tensioner	Color Coordinated
Warranty	Limited Lifetime

OPTIONS	
Two-on-One Headrail Option (Std Cordloop ONLY) <b>not available</b> with Cordless Lift or Motorized systems	Yes
Cordless Lift	Yes
Control positions	Left or Right
Fabric Headrail Insert	Yes
Hold-down brackets	Yes
Spacer blocks	Yes
Tilt Only (Standard Cordloop ONLY)	Yes
Specialty shapes	No
Tile cut-out	No
Cord Loop Drop	Yes

MOTORIZATION OPTIONS	
<b>Simplicity Rechargeable</b>	Yes
- Remote	Black or White
- Plug-in Charger	Yes
- Solar Panel Charger	Yes
<b>PowerWand Motorization (Rechargeable)</b>	Yes
- Wand Length	1, 2, 3, 4, 5 feet
- Wand Color	Black or White
- Wand Position	Left or Right
- Plug-in Charger	Yes

## CORD LOOP LENGTH

Translucent	
Ordered Length	Cord Length
16" to 19-7/8"	12"
20" to 26-7/8"	18"
27 to 39-7/8"	24"
40" to 59-7/8"	36"
60" to 83-7/8"	48"
84" to 107-7/8"	60"
108" to 120"	72"

Light Dimming	
Ordered Length	Cord Length
16" to 19-7/8"	12"
20" to 26-7/8"	18"
27 to 39-7/8"	24"
40" to 59-7/8"	36"
60" to 83-7/8"	48"
84" to 102"	60"

## MOUNTING REQUIREMENTS

INSIDE MOUNT	
Minimum casement depth*	1-1/2"
Minimum casement depth*, fully recessed	3-3/4"
Minimum rear fabric clearance	1/8"

OUTSIDE MOUNT	
Minimum mounting surface height	3-1/8"
Recommended width overlap per side	3"
Minimum rear fabric clearance	1/8"

## FINISHED DIMENSIONS

NOTE: WIDTH AND HEIGHT MAY VARY ± 1/8"

INSIDE MOUNT – Standard Deductions		
	Standard Cord Loop	
	Single Shade	2-on-1 Headrail
Headrail unit	1/8" less than ordered width	1/8" less than ordered width
Fabric width	1" less than ordered width	1" less than ordered width
Shading height	1/8" less than ordered height	1/8" less than ordered height
Fabric Gap	N/A	3/8"
OUTSIDE MOUNT – Standard Deductions		
	Standard Cord Loop	
	Single Shade	2-on-1 Headrail
Headrail unit	ordered width	ordered width
Fabric width	3/4" less than ordered width	3/4" less than ordered width
Shading height	1/8" less than ordered height	1/8" less than ordered height
Fabric Gap	N/A	3/8"

INSIDE MOUNT – Standard Deductions			
	Cordless Lift	Simplicity Rechargeable	PowerWand™
Headrail unit	1/8" less than ordered width	1/8" less than ordered width	1/8" less than ordered width
Fabric width	3/4" less than ordered width	1-1/8" less than ordered width	1" less than ordered width
Shading height	1/8" less than ordered height	1/8" less than ordered height	1/8" less than ordered height
OUTSIDE MOUNT – Standard Deductions			
	Cordless Lift	Simplicity Rechargeable	PowerWand™
Headrail unit	ordered width	ordered width	ordered width
Fabric width	5/8" less than ordered width	1" less than ordered width	3/4" less than ordered width
Shading height	1/8" less than ordered height	1/8" less than ordered height	1/8" less than ordered height

## OPTIONS

### FABRIC HEADRAIL INSERT

Features a coordinating fabric inserted into the front of the headrail to provide a soft fabric look from top to bottom.  
(See surcharge on pricing pages)



### SIDE-BY-SIDE VANE ALIGNMENT

When window shadings are installed side by side, vane alignment can be guaranteed within 1/4" only if:

- Shadings are ordered at the same time and in the identical style, color and height.
- Shadings that need to be aligned are specified on the order form (a note must be included in Special Instructions).

### ADJACENT SHADINGS

To span wide window openings, window shadings may be installed adjacently, so their headrails abut. The gap between the fabric panels of the adjacent shadings varies according to the control placement, as shown in the table below.

CONTROL PLACEMENT	
Adjacent (Abutting) Window Shadings	
Left/Right Shadings	Center Gap
Right/Right Controls	3/4"
Left/Left Controls	3/4"
Right/Left Controls	1-1/16"
Left/Right Controls	1/2"
Window shadings are not recommended for bay windows or butt-and-pass applications.	

## ADDITIONAL NOTES

### SHADING ADJUSTMENT

Shadings should wind evenly and not skew to one side.

A balance weight on the bottomrail can easily be adjusted if the fabric winds unevenly on the roll when the window shading is raised. Uneven winding can cause damage to the edge of the fabric.

- If skewing does occur:
  - Ensure headrail was installed level; shim if necessary.
  - To release, insert a flat blade screwdriver into the weight lock and turn clockwise.
  - Adjust placement of weight in bottomrail, 1" at a time, toward side where fabric is gathering.
  - Secure the weight locks in position by turning them counter clockwise, after making the adjustment.
  - Raise shade, then lower, if necessary, adjust again.

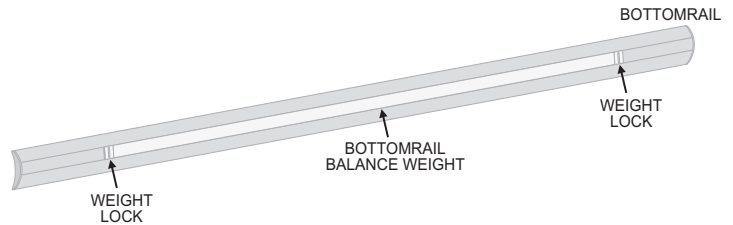

### MAGNETIC HOLD-DOWN BRACKETS

Magnetic hold-down brackets secure the bottom of the shading to prevent swaying. Available upon request. Standard on tilt-only shadings.

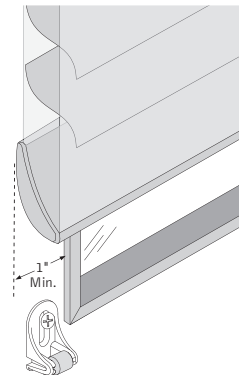



# STANDARD SHADING OPERATION

## STANDARD SHADING OPERATION

Referring to the illustration below.

- 1) Shading in fully raised position.
- 2) Pull down on rear half of the cord loop to lower shading and open fabric vanes.
- 3) Pull down on front half of the cord loop to close vanes and raise shading.

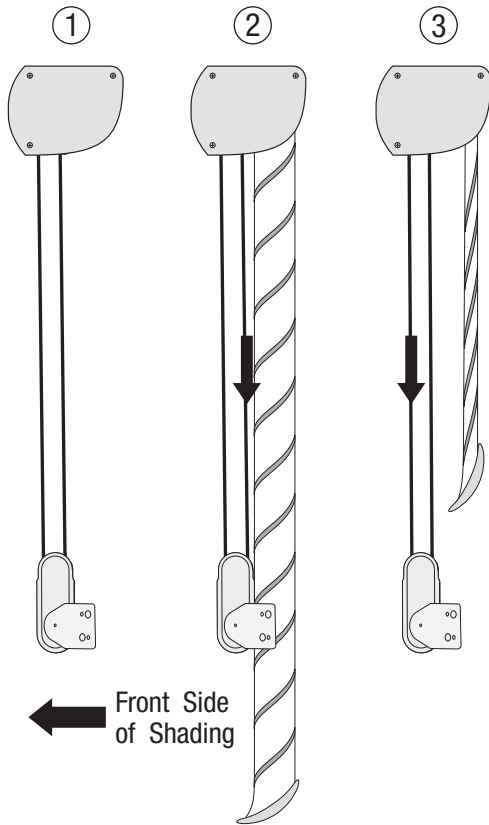

## Light Control

With the shading in the fully lowered position, the cord loop is used to adjust the fabric vanes from open to closed, and anywhere in between. Light control is at your customer's fingertips. (Note: The degree of maximum vane closure varies slightly from the top to the bottom of the shading.)

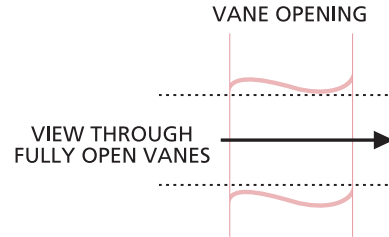

## Vane Opening

Vane opening is the amount of unobstructed visibility between fully open vanes when looking through the shading at eye level. Vane opening for shadings is up to 1-1/4".

## Vane Closure

When the vanes of a window shading are closed, they overlap each other, blocking the view. However, the vanes do not contact each other along the full length of the shading – they do not form a perfect seal against light leakage. This is most visible toward the bottom of the shading.

Vane closure is measured as the distance between the front and rear fabric facings 6" up from the lowest point of the bottomrail, with the shading fully lowered and the vanes closed, as illustrated here. Vane closure is 5/8" for shadings under 96" in height and 7/8" for shadings over 96" in height.

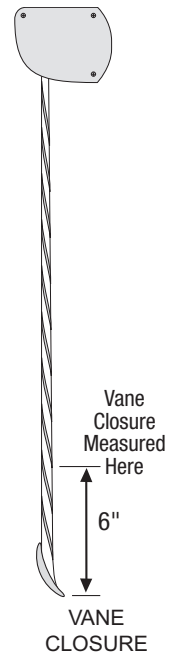

**PLEASE NOTE:** Cord tensioner MUST be mounted to window casement or wall in order for the shade to operate.

## Cordless Operation

### To Lower The Shade

- Pull down on the tassel until the shade is at the desired height.

### To Raise The Shade

- Gently pull down on the tassel. To raise the shade completely, simply release the tassel and the shade will roll up fully into the headrail. To raise the shade partially, when the shade is at the desired height, gently pull on the tassel to stop the shade from raising.



Optional cordless lift control only

## SIMPLICITY RECHARGEABLE MOTORIZATION: OVERVIEW

### Simplicity Rechargeable

- The Rechargeable Simplicity motor program features an integrated rechargeable lithium ion battery in the motor casing and is fully concealed by the inner tube.
- Rechargeable battery is included with the motor. The average battery charge will last 6-12 months based on an average sized shade raised and lowered once per day. The life of the battery charge will vary based on the type of window covering selected, the size and weight of the window covering and the number of times the shade is operated on a daily basis. The battery can be recharged up to 500 times. It takes approximately 5 hours to recharge the motor when fully depleted. Charging port available on the right side only.

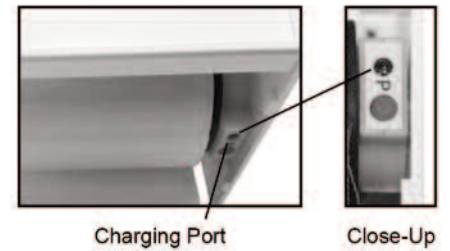

### Battery Charger

- An 8.4 Volt charger requires a standard power outlet to recharge the battery. The charger must be specified when ordering Simplicity Rechargeable Motorized shade option. The charger plugs into the charging port of the motor. The charger is black and comes with a 156" wire. The dimensions are 1" wide x 2-1/2" length x 1-3/4" deep. Sold separately.



### Solar Panel Recharge Option

- Plugs in to any Simplicity Rechargeable motorized shading (does not work with PowerWand). Provides constant trickle charge to 7.4v Li-ION Rechargeable battery packs. Does not require direct sunlight, but performs best in regular direct sunlight applications. Will prolong the life of the charge of the 7.4v rechargeable battery packs, and in some applications will maintain charge indefinitely.
- Life of charge is subject to application variables such as size and weight of shade, frequency of use, amount of direct sunlight exposure, etc.



### 5 Channel Remote

- The remote can operate up to five shadings simultaneously, individually or in groups. Remotes and holders are available in white or black. The remote comes with a holder which can be mounted to a wall for easy storage. The range of the remote is approximately 80 feet.



Please Note:

- Not all motors run at the same rate of speed.
- Simplicity motors have a "Favorites" position setting. To set a "Favorites" position, follow instructions provided in the installation instructions.

---

## POWERWAND MOTORIZATION: OVERVIEW

---

### PowerWand™ Motorization

- Shadings can be fabricated with the PowerWand Rechargeable Push Button Control option. The PowerWand Rechargeable option is an easy, cord free motorized operation for the budget savvy homeowner. PowerWand Rechargeable uses Simplicity motors and components.

### PowerWand Rechargeable Shades Operation

- Press the up or down button on the pendant to raise or lower the shading to your desired position. No programming is required with PowerWand as upper and lower limits are set at the factory. If desired, upper and lower limits can be adjusted in the field.
- Please refer to the installation instructions for instructions on resetting the upper and lower limits and setting a favorites position can be programmed on-site.

### PowerWand Appearance

- The PowerWand Rechargeable wand and pendant is attached to the head rail and requires no additional mounting.
- The wand and pendant hangs down the front of the shades from the head rail.
- Pendant is 2-1/2" long.
- The pendant does not need to be mounted to the wall to operate the shade.



### PowerWand Options

- Wand is available in Black or White (there is no default)
- Wand is available in 1 foot increments from 1 to 5 feet (there is no default)
- Wand is available on either the right or left side of the shade (there is no default)



White



Black Shown with Plug-In Charger

### PowerWand Battery Life

- The battery life will vary based on the type of window covering selected, the size and weight of the window covering and the number of times you operate the blind on a daily basis.

### Battery Charger

- 8.4 Volt charger requires a standard power outlet to recharge the battery. The charger must be specified when ordering the PowerWand motorization option. The charger plugs into the charger port on the side of the pendant. The charger is black and comes with a 156" wire. The dimensions are 1" wide x 2-1/2" length x 1-3/4" deep.



# PRODUCT COMPONENTS – STANDARD

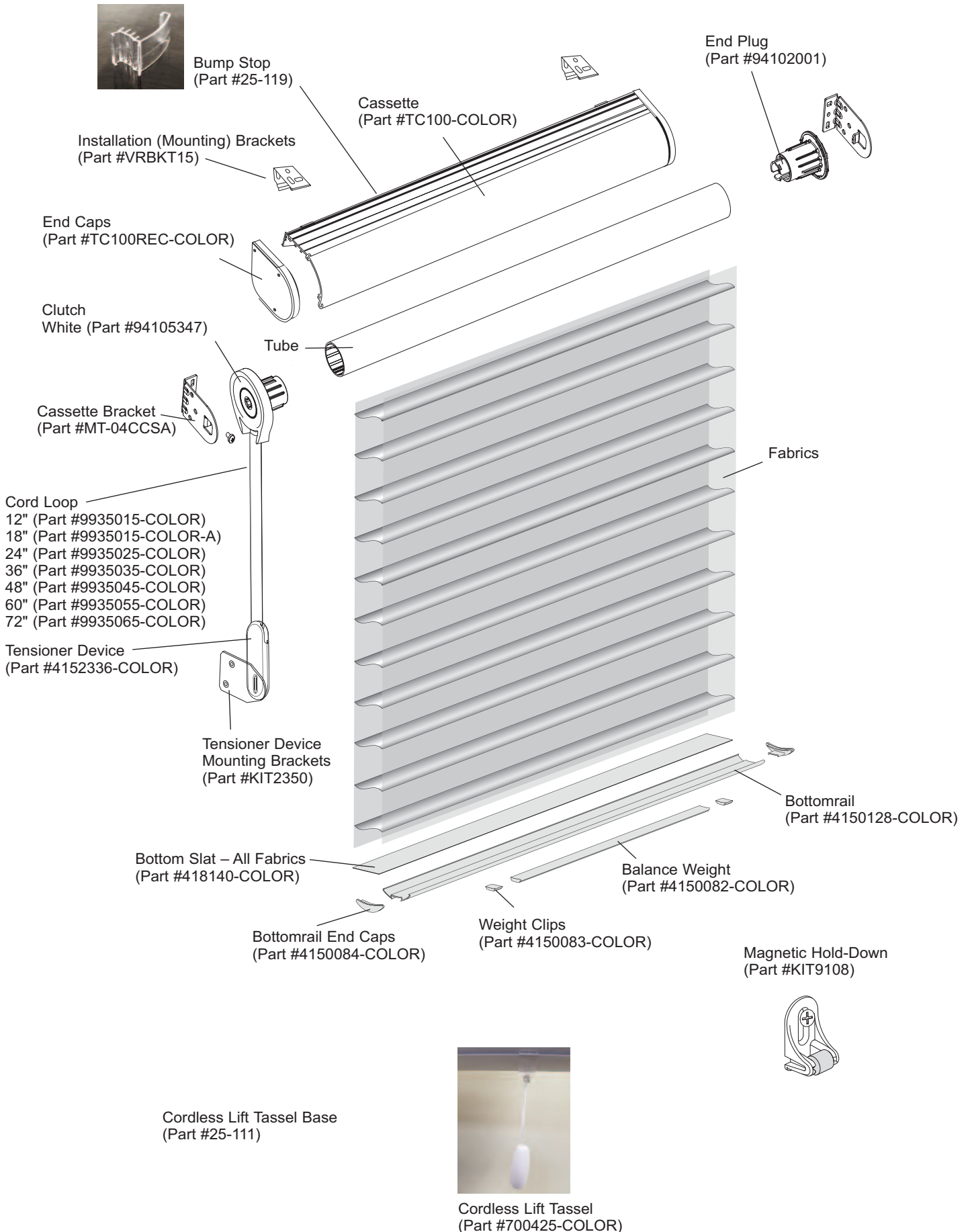

# PRODUCT COMPONENTS – SIMPLICITY RECHARGEABLE MOTORIZATION

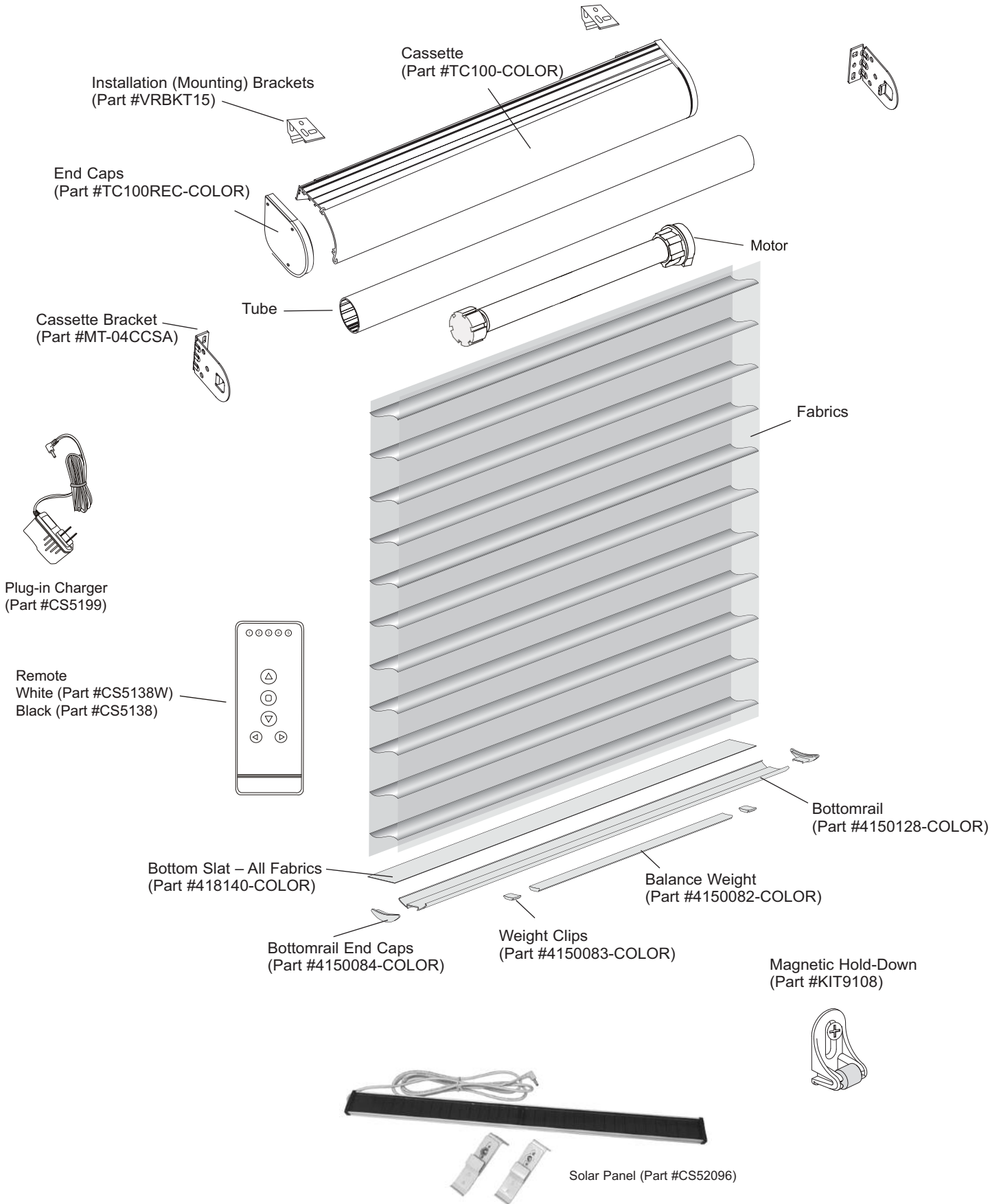

# PRODUCT COMPONENTS – POWERWAND MOTORIZATION

