

TEXTON



# WINDOW SHADINGS

Effective February 4, 2019

*design simplified™*

---

# TABLE OF CONTENTS

---

## Product Overview

- Features & Benefits ..... 2
- Collection Information (includes Light Control) ..... 3-4

## Pricing Groups

- Pricing Group 1 (Standard and Options) ..... 5
- Pricing Group 2 (Standard and Options) ..... 6
- Motorization Surcharges ..... 7

## Product Specifications

- Features & Options, Cord Loop Drop Chart ..... 8
- Mounting Requirements & Finished Dimensions ..... 9
- Options and Additional Notes ..... 10-12
- Simplicity Rechargeable Motorization: Overview ..... 13
- PowerWand Motorization: Overview ..... 14
- RemoteLift™ 2.0 Product Configuration Specifications ..... 15
- Standard Shading Operation ..... 16
- Retractable Cord and Cordless Shading Operation ..... 17
- Product Components – Standard ..... 18
- Product Components – Retractable Cord ..... 19
- Product Components – Cordless Lift ..... 20
- Product Components – Simplicity Rechargeable Motorization ..... 21
- Product Components – Powerwand™ Motorization ..... 22
- Product Components – Remotelift™ 2.0 ..... 23

### **Oversize Common Carrier Delivery**

All orders with any quantity of shades or blinds or any continuous valance 96" or more in width are considered oversize. Therefore, a net shipping charge of \$40 per oversized unit will be assessed.

Oversized orders that require expedited shipping will be quoted and charged accordingly.

Please see General Information for additional freight and shipping charge information.

## FEATURES & BENEFITS



- Three vane sizes complement any window, providing desired view through – available in 2", 2 1/2" and 3" for decorating flexibility.
- Available in translucent and light-dimming vane styles to provide varying degrees of light control.
- Filters out up to 88% of incoming harmful UV rays when open, and up to 99% when closed.
- Covers large window expanses with no visible internal lift cords to detract from their elegant appearance.
- When raised, they completely disappear into the headrail allowing more outside view.
- Standard cord loop, retractable cord control, cordless lift and battery-operated Simplicity Rechargeable, PowerWand, and RemoteLift 2.0 motorization options for operating convenience.
- Cordless lift, Simplicity Rechargeable, PowerWand, and battery-operated RemoteLift 2.0 motorization shades are certified Best for Kids.
- Fabric-covered headrail option for a soft look top to bottom.
- Limited Lifetime Warranty ensures your customers' satisfaction.

Now available with  
PowerWand™

# COLLECTION INFORMATION

Family Name	Color Name	Family Code	Color #	Coordinating Hardware Color Number	Coordinating Hardware Color Name	Light Control	Price Group
<b>Classic</b> 2-1/2" Translucent N8	Applesauce	N8	226	551	Wom Leather	B	1
	Beige Glow	N8	203	320	Rich Cream	B	1
	Cashmere	N8	206	320	Rich Cream	B	1
	Cityscape	N8	238	426	Squirrel Gray	B	1
	Comfy Khakis	N8	199	180	Dove Gray	B	1
	Dried Basil	N8	065	426	Squirrel Gray	B	1
	Dusky View	N8	208	679	Buff Beige	B	1
	French Bread	N8	222	679	Buff Beige	B	1
	Mariner Blue	N8	224	469	Blue Creek	B	1
	Snow Cap	N8	201	661	White Tiara	B	1
Sun Dream	N8	202	320	Rich Cream	B	1	
<b>Coastal</b> 2" Translucent SL2	Foam	SL2	700	885	Flex White	B	1
	Mystery	SL2	761	426	Squirrel Gray	B	1
	Sand	SL2	701	320	Rich Cream	B	1
	Sculpting Clay	SL2	760	180	Dove Gray	B	1
	Seashell	SL2	703	679	Buff Beige	B	1
Sunrise	SL2	702	320	Rich Cream	B	1	
<b>Coastal</b> 3" Translucent SA3	Foam	SA3	700	885	Flex White	B	1
	Mystery	SA3	761	426	Squirrel Gray	B	1
	Sand	SA3	701	320	Rich Cream	B	1
	Sculpting Clay	SA3	760	180	Dove Gray	B	1
	Seashell	SA3	703	679	Buff Beige	B	1
Sunrise	SA3	702	320	Rich Cream	B	1	
<b>Passion</b> 2-1/2" Translucent P9	Classic Cream	P9	254	350	Vanilla	B	1
	Destiny's Dream	P9	253	661	White Tiara	B	1
	Heather White	P9	250	661	White Tiara	B	1
	Hint of Spice	P9	255	319	Earthen Beige	B	1
	Spiced Vinegar	P9	251	320	Rich Cream	B	1
Touch of Beige	P9	252	320	Rich Cream	B	1	
<b>Retreat</b> 2" Light Dimming SR2	Alpine	SR2	300	885	Flex White	C	2
	Antique	SR2	302	329	Summer Linen	C	2
	Faded Gray	SR2	331	551	Wom Leather	C	2
	Nickel	SR2	332	426	Squirrel Gray	C	2
	Sunset	SR2	301	320	Rich Cream	C	2
	Swiss Coffee	SR2	330	656	Golden Straw	C	2
<b>Retreat</b> 3" Light Dimming SR3	Alpine	SR3	300	885	Flex White	C	2
	Antique	SR3	302	329	Summer Linen	C	2
	Ash Gray	SR3	351	426	Squirrel Gray	C	2
	Cloud	SR3	309	320	Rich Cream	C	2
	Coffee Bean	SR3	308	849	Mocha	C	2
	Faded Gray	SR3	331	551	Wom Leather	C	2
	Nickel	SR3	332	426	Squirrel Gray	C	2
	Pebble	SR3	311	810	Mushroom	C	2
	Rock Garden	SR3	350	002	Alabaster	C	2
	Stone	SR3	310	656	Golden Straw	C	2
Sunset	SR3	301	320	Rich Cream	C	2	
Swiss Coffee	SR3	330	656	Golden Straw	C	2	
<b>Slub Style</b> 2-1/2" Translucent N10	Aloe Vera	N10	065	451	Lichen	B	1
	Chiffon	N10	213	320	Rich Cream	B	1
	Honey Roast	N10	222	679	Buff Beige	B	1
	Misty Seas	N10	238	426	Squirrel Gray	B	1
	Seashell	N10	204	320	Rich Cream	B	1
	Sugar Cane	N10	201	661	White Tiara	B	1
	Tea Time	N10	220	319	Earthen Beige	B	1
Willow Herb	N10	226	551	Wom Leather	B	1	

\* Light Dimming fabrics provide category C, opaque light control because even when the vanes are completely closed they DO NOT completely seal off all incoming light. See vane closure diagram on page 16 for a visual reference.

Note: Collections are presented alphabetically. Within each collection colors are also arranged alphabetically



**A. Glare Reducing**

Softly filters light and reduces glare. Images, shapes and people can be seen clearly. Provides the least amount of light and shape screening.



**B. Filtering**

Filters strong light. Images, shapes and people can be seen with some clarity. Provides a modest degree of light and shape screening.



**C. Shading**

Significantly reduces light. Images, shapes and people cannot be seen clearly. Provides a moderate to strong degree of light and shape screening.



**D. Blocking**

Dramatically reduces light. Images, shapes and people are not distinguishable. Provides privacy against most all direct light and shape screening (except minimal light that may seep through closed or overlapping opaque/blackout vanes).



**E. Blackout**

Blocks out virtually all light (except light that may enter on the sides of the shade) for maximum privacy and darkness.

# COLLECTION INFORMATION

Family Name	Color Name	Family Code	Color #	Coordinating Hardware Color Number	Coordinating Hardware Color Name	Light Control	Price Group
<b>Soft Stripe</b> 2-1/2" Translucent N14	Banana Split	N14	205	350	Vanilla	B	1
	Crème Brulee	N14	203	320	Rich Cream	B	1
	Ground Ginger	N14	226	551	Wom Leather	B	1
	Honey Butter	N14	222	679	Buff Beige	B	1
	Swan Song	N14	201	661	White Tiara	B	1
	Vanilla Milk Shake	N14	204	320	Rich Cream	B	1
<b>Solitude</b> 2-1/2" Light Dimming M16	Citron	M16	205	350	Vanilla	C	2
	Jute	M16	203	679	Buff Beige	C	2
	Parchment	M16	201	320	Rich Cream	C	2
	Soft Souffle	M16	204	551	Wom Leather	C	2
	Sunlit Crème	M16	202	320	Rich Cream	C	2
	Swan White	M16	200	661	White Tiara	C	2
<b>Sophisticate</b> 2" Translucent SS2	Applesauce	SS2	607	350	Vanilla	B	1
	Blue Wave	SS2	630	469	Blue Creek	B	1
	City Sidewalk	SS2	631	810	Mushroom	B	1
	Eggnog	SS2	605	320	Rich Cream	B	1
	Glacier	SS2	616	661	White Tiara	B	1
	Lily	SS2	601	885	Flex White	B	1
	Mist	SS2	602	661	White Tiara	B	1
	Moonlight	SS2	603	320	Rich Cream	B	1
	Natural Linen	SS2	619	002	Alabaster	B	1
	Opal	SS2	604	320	Rich Cream	B	1
	Pearl Grey	SS2	617	320	Rich Cream	B	1
	Pencil Sketch	SS2	632	426	Squirrel Gray	B	1
	Praline	SS2	609	350	Vanilla	B	1
	Sandstone	SS2	606	319	Earthen Beige	B	1
Treasure Map	SS2	633	002	Alabaster	B	1	
<b>Sophisticate</b> 3" Translucent SS3	Applesauce	SS3	607	350	Vanilla	B	1
	Blue Wave	SS3	630	469	Blue Creek	B	1
	City Sidewalk	SS3	631	810	Mushroom	B	1
	Eggnog	SS3	605	320	Rich Cream	B	1
	Glacier	SS3	616	661	White Tiara	B	1
	Lily	SS3	601	885	Flex White	B	1
	Mist	SS2	602	661	White Tiara	B	1
	Moonlight	SS3	603	320	Rich Cream	B	1
	Natural Linen	SS3	619	002	Alabaster	B	1
	Opal	SS3	604	320	Rich Cream	B	1
	Pearl Grey	SS3	617	320	Rich Cream	B	1
	Pencil Sketch	SS3	632	426	Squirrel Gray	B	1
	Praline	SS3	609	350	Vanilla	B	1
	Sandstone	SS3	606	319	Earthen Beige	B	1
Treasure Map	SS3	633	002	Alabaster	B	1	
<b>Villa</b> 2-1/2" Light Dimming N6	Castle Stone	N6	226	551	Wom Leather	C	2
	Coral	N6	202	320	Rich Cream	C	2
	Cotton	N6	201	885	Flex White	C	2
	Fawn	N6	203	320	Rich Cream	C	2
	Graphite	N6	238	426	Squirrel Gray	C	2
	Island Blue	N6	224	469	Blue Creek	C	2
	Spanish Olive	N6	065	451	Lichen	C	2
	White Sand	N6	213	885	Flex White	C	2

\* Light Dimming fabrics provide category C, opaque light control because even when the vanes are completely closed they DO NOT completely seal off all incoming light. See vane closure diagram on page 16 for a visual reference.

Note: Collections are presented alphabetically. Within each collection colors are also arranged alphabetically



### A. Glare Reducing

Softly filters light and reduces glare. Images, shapes and people can be seen clearly. Provides the least amount of light and shape screening.



### B. Filtering

Filters strong light. Images, shapes and people can be seen with some clarity. Provides a modest degree of light and shape screening.



### C. Shading

Significantly reduces light. Images, shapes and people cannot be seen clearly. Provides a moderate to strong degree of light and shape screening.



### D. Blocking

Dramatically reduces light. Images, shapes and people are not distinguishable. Provides privacy against most all direct light and shape screening (except minimal light that may seep through closed or overlapping opaque/blackout vanes).



### E. Blackout

Blocks out virtually all light (except light that may enter on the sides of the shade) for maximum privacy and darkness.

**2" Translucent**  
Coastal (SL2)  
Sophisticate (SS2)

**2 1/2" Translucent**  
Classic (N8)  
Passion (P9)  
Slub Style (N10)  
Soft Stripe (N14)

**3" Translucent**  
Coastal (SA3)  
Sophisticate (SS3)

**GROUP 1**

WIDTH TO:	24"	30"	36"	42"	48"	54"	60"	66"	72"	76"	84"	90"	96"	102"	109"	120"
HEIGHT TO:																
36"	\$678	761	847	932	1016	1108	1186	1275	1497	1585	1673	1761	1842	1958	2193	2393
42"	712	808	897	993	1083	1181	1275	1368	1593	1695	1787	1885	1974	2098	2347	2566
48"	756	850	955	1051	1154	1257	1366	1469	1700	1803	1903	2004	2111	2235	2502	2729
54"	785	895	1001	1117	1227	1337	1451	1577	1800	1910	2020	2136	2253	2392	2683	2929
60"	825	943	1058	1172	1288	1423	1545	1675	1896	2022	2143	2273	2402	2566	2884	3151
66"	861	989	1113	1234	1368	1505	1645	1784	1999	2137	2276	2420	2559	2737	3090	3373
72"	897	1033	1167	1300	1446	1593	1743	1889	2111	2257	2406	2559	2705	2897	3277	3577
78"	923	1065	1209	1361	1506	1661	1816	1976	2207	2372	2525	2687	2834	3044	3446	3762
84"	961	1113	1261	1426	1585	1750	1919	2082	2322	2497	2662	2825	2989	3208	3636	3967
90"	1000	1154	1318	1492	1661	1841	2013	2187	2434	2612	2793	2968	3140	3366	3817	4164
96"	1041	1206	1371	1558	1743	1921	2104	2287	2548	2737	2925	3106	3291	3537	4008	4374
102"	1188	1378	1565	1769	1956	2134	2381	2617	2797	2985	3183	3361	3547	3773	4258	4648
108"	1249	1448	1645	1860	2056	2248	2504	2758	2943	3145	3346	3542	3736	3970	4484	4897
114"	1325	1535	1748	1976	2189	2388	2660	2927	3128	3343	3547	3755	3960	4212	4751	5188
120"	1426	1645	1874	2116	2335	2559	2847	3131	3346	3576	3805	4020	4241	4509	5085	5553

STANDARD FEATURES
<ul style="list-style-type: none"> <li>• Headrail Size: 3-1/4" x 3-1/16"</li> <li>• Snap-in Bracket Style</li> <li>• Cord Tilt &amp; Lift</li> <li>• Color-Coordinated Hardware</li> </ul>

OPTIONS: EXTRA CHARGE
<ul style="list-style-type: none"> <li>• Fabric-Covered Headrail Surcharge . . . . . add \$66 per shading</li> <li>• Hardware Color Substitution Surcharge . . . . . add \$38 per shading</li> <li>• Cordless Lift Surcharge . . . . . add \$134 per shading</li> <li>• Retractable Cord Control Surcharge . . . . . add \$118 per shading</li> <li>• Retractable Cord Two-on-One Headrail . . . . . add \$235</li> <li>• Motorization . . . . . see page 7</li> </ul>

SIZE STANDARDS	Standard Loop	Retractable Cord
Minimum ordered width	12"	12"
Minimum ordered width – tilt only	6"	N/A
Maximum ordered width	120"	120"
Maximum ordered width end mount	48"	48"
Maximum ordered width – tilt only	11-7/8"	N/A
Minimum ordered height	16"	16"
Maximum ordered height – translucent	120"	120"

TWO-ON-ONE HEADRAIL	Standard Loop	Retractable Cord
Minimum ordered width	24"	24"
Maximum ordered width	144"	144"
Maximum height	120"	120"
Center gap	3/8"	3/8"

**Note:** Two-On-One Headrail option not available for end mount applications.  
**Note:** Two-On-One Headrail option not available with Cordless Lift, RemoteLift 2.0, PowerWand, or Simplicity Motorization

POWERWAND™ UPGRADE	
Minimum ordered width	21"
Maximum ordered width	120"
Maximum ordered width end mount	48"
Minimum ordered height	12"
Maximum ordered height – Translucent	96"
<b>Maximum Square Feet - Translucent</b>	<b>60</b>

**Note:** Wand available on RIGHT side only.

OPTIONS: NO CHARGE – SPECIFY ON ORDER
<ul style="list-style-type: none"> <li>• Tilt Only Shadings 6" to 11-7/8" (standard only)</li> <li>• Two-On-One Headrail – price as 2 separate shades (standard)</li> <li>• Control Positions (R or L)</li> <li>• Spacer Blocks</li> <li>• Extension Brackets</li> <li>• Hold-Down Brackets</li> <li>• Back Cover for Inside or End Mounts</li> <li>• Dust Cover for Outside Mounts</li> </ul>

SIZE STANDARDS	Cordless Lift
Minimum ordered width	18"
Maximum ordered width	84"
Maximum ordered width end mount	N/A
Minimum ordered height	16"
Maximum ordered height – Translucent	84"

**Note:** Two-On-One Headrail option not available with cordless lift  
**Note:** End Mount not available with cordless lift

REMOTELIFT 2.0 MOTORIZATION UPGRADE	
Minimum ordered width	12" or 20"***
Maximum ordered width	120"
Maximum ordered width end mount	48"
Minimum ordered height	12"
Maximum ordered height – translucent	120"

\*\*\* Satellite Battery Pack or DC Power Supply = 12" min. Battery Wand = 20" min.

SIMPLICITY MOTORIZATION UPGRADE	
Minimum ordered width	21"
Maximum ordered width	120"
Maximum ordered width end mount	48"
Minimum ordered height	12"
Maximum ordered height – Translucent	96"
<b>Maximum Square Feet - Translucent</b>	<b>60</b>

**GROUP 2**

**2" Light Dimming  
Retreat (SR2)**

**2 1/2" Light Dimming  
Solitude (M16)  
Villa (N6)**

**3" Light Dimming  
Retreat (SR3)**

WIDTH TO:	24"	30"	36"	42"	48"	54"	60"	66"	72"	76"	84"	90"	96"	102"	109"	120"
<b>HEIGHT TO:</b>																
36"	\$749	840	934	1028	1119	1217	1305	1403	1641	1745	1841	1940	2029	2153	2418	2639
42"	785	893	989	1092	1197	1300	1403	1505	1759	1864	1967	2072	2175	2306	2577	2813
48"	829	936	1051	1154	1272	1384	1503	1615	1864	1977	2091	2205	2319	2457	2756	3007
54"	865	985	1108	1229	1341	1469	1595	1727	1976	2102	2219	2353	2488	2633	2962	3233
60"	905	1033	1165	1291	1423	1561	1707	1842	2084	2219	2360	2504	2648	2818	3170	3462
66"	945	1080	1227	1366	1505	1656	1810	1963	2198	2354	2507	2660	2811	3010	3400	3713
72"	989	1135	1284	1428	1590	1759	1912	2073	2319	2488	2649	2811	2969	3186	3649	3981
78"	1016	1169	1332	1494	1656	1835	2001	2177	2431	2603	2785	2955	3124	3350	3913	4273
84"	1058	1227	1384	1563	1748	1924	2113	2287	2559	2745	2927	3281	3428	3565	4198	4582
90"	1103	1272	1446	1638	1833	2022	2214	2401	2671	2872	3227	3425	3574	3794	4404	4808
96"	1261	1446	1636	1839	2024	2207	2429	2646	2975	3161	3350	3540	3723	3981	4623	5046
102"	1444	1650	1864	2091	2271	2449	2749	3025	3265	3455	3647	3826	4015	4257	4907	5359

STANDARD FEATURES
<ul style="list-style-type: none"> <li>• Headrail Size: 3-1/4" x 3-1/16"</li> <li>• Snap-in Bracket Style</li> <li>• Cord Tilt &amp; Lift</li> <li>• Color-Coordinated Hardware</li> </ul>

OPTIONS: EXTRA CHARGE
<ul style="list-style-type: none"> <li>• Fabric-Covered Headrail Surcharge . . . . . add \$66 per shading</li> <li>• Hardware Color Substitution Surcharge . . add \$38 per shading</li> <li>• Cordless Lift Surcharge . . . . . add \$134 per shading</li> <li>• Retractable Cord Control Surcharge . . . . add \$118 per shading</li> <li>• Retractable Cord Two-on-One Headrail . . . . . add \$235</li> <li>• Motorization . . . . . see page 7</li> </ul>

OPTIONS: NO CHARGE – SPECIFY ON ORDER
<ul style="list-style-type: none"> <li>• Tilt Only Shadings 6" to 11-7/8" (standard only)</li> <li>• Two-On-One Headrail – price as 2 separate shades (standard)</li> <li>• Control Positions (R or L)</li> <li>• Spacer Blocks</li> <li>• Extension Brackets</li> <li>• Hold-Down Brackets</li> <li>• Back Cover for Inside or End Mounts</li> <li>• Dust Cover for Outside Mounts</li> </ul>

SIZE STANDARDS	Standard Loop	Retractable Cord
Minimum ordered width	12"	12"
Minimum ordered width – tilt only	6"	N/A
Maximum ordered width	120"	120"
Maximum ordered width end mount	48"	48"
Maximum ordered width – tilt only	11-7/8"	N/A
Minimum ordered height	16"	16"
Maximum ordered height – light dimming	102"	102"

SIZE STANDARDS	Cordless Lift
Minimum ordered width	18"
Maximum ordered width	84"
Maximum ordered width end mount	N/A
Minimum ordered height	16"
Maximum ordered height – light dimming	84"

**Note:** Two-On-One Headrail option not available with cordless lift

**Note:** End Mount not available with cordless lift

TWO-ON-ONE HEADRAIL	Standard Loop	Retractable Cord
Minimum ordered width	24"	24"
Maximum ordered width	144"	144"
Maximum height	102"	102"
Center gap	3/8"	3/8"

**Note:** Two-On-One Headrail option not available for end mount applications.

**Note:** Two-On-One Headrail option not available with Cordless Lift, Remotelift 2.0, PowerWand, or Simplicity Motorization

REMOTELIFT 2.0 MOTORIZATION UPGRADE	
Minimum ordered width	12" or 20***
Maximum ordered width	120"
Maximum ordered width end mount	48"
Minimum ordered height	12"
Maximum ordered height – light dimming	102"

\*\* Satellite Battery Pack or DC Power Supply = 12" min. Battery Wand = 20" min.

POWERWAND™ UPGRADE	
Minimum ordered width	21"
Maximum ordered width	120"
Maximum ordered width end mount	48"
Minimum ordered height	12"
Maximum ordered height - light dimming	84"
<b>Maximum Square Feet</b> - light dimming	<b>50</b>

**Note:** Wand available on RIGHT side only.

SIMPLICITY MOTORIZATION UPGRADE	
Minimum ordered width	21"
Maximum ordered width	120"
Maximum ordered width end mount	48"
Minimum ordered height	12"
Maximum ordered height - light dimming	84"
<b>Maximum Square Feet</b> - light dimming	<b>50</b>

Motorization consists of a **motor, power source, and controller**. Be sure all of these elements are included when determining final price.

**SIMPLICITY RECHARGEABLE OPTIONS: EXTRA CHARGE – SPECIFY ON ORDER**  
USE APPROPRIATE GRID FOR SHADE PRICE, THEN ADD EXTRA CHARGE(S) BELOW.

- Simplicity Rechargeable Motor .....add \$489 per motor
- 5 Channel Remote Control (Black Part #CS5138 or White Part #CS5138W) .....add \$72 each
- Solar Panel (Part #CS52096 Solar Panel & mounting brackets) (Part #02-70-9021 Mounting bracket screws) .....add \$267 each
- PowerWand .....add \$196 each
- Plug-in Charger (Can be used for both Simplicity Rechargeable and PowerWand) (Part #CS5199) .....add \$54 each

**REMOTELIFT™ MOTORIZATION OPTIONS: EXTRA CHARGE – SPECIFY ON ORDER**

- Motorization .....add \$788 per shading
- Remote Control..... Part #2984495100 .....add \$95 each
- Wireless Wall Switch..... Part #2986350100 .....add \$130 each
- Satellite Battery Pack – select with wire length below..... Part #KIT2520
- Satellite Battery Pack – with 15" wire ..... Part #2989899000 .....add \$111 each
- Satellite Battery Pack – with 4' wire ..... Part #2989900000 .....add \$123 each
- Satellite Battery Pack – with 10' wire ..... Part #2989901000 .....add \$143 each
- Satellite Battery Pack – with 20' wire ..... Part #2989902000 .....add \$160 each
- DC Power Supply – select with wire length below..... Part #7806000000
- DC Power Supply – with 15" wire ..... Part #2989899000 .....add \$166 each
- DC Power Supply – with 4' wire ..... Part #2989900000 .....add \$168 each
- DC Power Supply – with 10' wire ..... Part #2989901000 .....add \$175 each
- DC Power Supply – with 20' wire ..... Part #2989902000 .....add \$182 each
- Daisy Chain Adapter – select with wire length below ..... Part #2989875000
- Daisy Chain Adapter – with 15" cable ..... Part #2989899000 .....add \$79 each
- Daisy Chain Adapter – with 4' cable ..... Part #2989900000 .....add \$89 each
- Daisy Chain Adapter – with 10' cable ..... Part #2989901000 .....add \$96 each
- Daisy Chain Adapter – with 20' cable ..... Part #2989902000 .....add \$105 each

Notes: For surcharges on oversize common carrier delivery, express ship program, shipments to Hawaii, Alaska and Puerto Rico, see General Information Section

**MOMENTA APP BRIDGE KIT**

- Momenta App Bridge Kit (includes one Momenta Extender Kit) .....Part #2920072100 (must be submitted as part order).....add \$128 NET Cost
- Momenta Extender Kit.....Part #2920075100 (must be submitted as part order).....add \$47 NET Cost



**REMOTELIFT 2.0 ORDERING NOTES**

- Specify Inside (IB), outside (OB) or end (EB) mount.
- Specify if optional back cover is desired with inside (IB) mounts or end (EB) mounts.
- Specify if additional spacer blocks or extension brackets are needed for added clearance.
- Specify left- or right-side motor assembly.
- Specify number of remote control units (at least 1 required per order).
- If ordering satellite battery pack, specify wire length (15", 4', 10' or 20').
- If ordering DC power supply, specify wire length (15", 4', 10' or 20').
- Specify if daisy-chain cables are required to daisy-chain 2 or 3 shadings together (requires DC power supply). If ordering, specify wire length (15", 4', 10' or 20')



# PRODUCT SPECIFICATIONS

FEATURES	
# of fabric styles	12
# of Colors	105
Headrail size	3-1/4" X 3-1/16"
Bracket style	Snap-in
Cord loop tilt and lift	Yes, Standard
Raise, lower and tilt with one cord	Yes
Safety cord tensioner	Color Coordinated
Warranty	Lifetime Limited

OPTIONS - EXTRA CHARGE	
Fabric Covered Headrail	Yes
Hardware Color Substitution	Yes
Retractable Cord Control*	Yes
Cordless Lift <small>Not available as Two-on-One headrail</small>	Yes
PowerWand Motorization <small>Not available as Two-on-One headrail</small>	Yes
Simplicity Motorization <small>Not available as Two-on-One headrail</small>	Yes
RemoteLift 2.0 Motorization <small>Not available as Two-on-One headrail</small>	Yes
OPTIONS - NO CHARGE	
Tilt Only (available on standard loop control only)	Yes
Two-On-One Headrail Option <small>Not available with Cordless Lift, PowerWand, Simplicity Motorization or RemoteLift</small>	Yes
Control positions <small>PowerWand and Simplicity RIGHT only</small>	R or L
Spacer blocks	Yes
Extension brackets	Yes
Hold-down brackets	Yes
Back cover (Inside or End Mounts)	Yes
Dust cover (Outside Mounts)	Yes
Cord length (See Cord Loop Drop Chart)	Yes
Specialty shapes	No
Tile cut-out	No

\* Retractable cord length will be 40% of shading height.

## CORD LOOP DROP CHART

SHADING HEIGHT	CORD LOOP DROP
16" to 26-7/8"	1 ft. (white-only)
27" to 39-7/8"	2 ft.
40" to 59-7/8"	3 ft.
60" to 83-7/8"	4 ft.
84" to 107-7/8"	5 ft.
108" to 120"	6 ft. (white-only)

OPTIONAL CORD DROPS (White Cord Only)	
CORD DROP	INCREMENTS
6' – 12'	6" increments
12' – 16'	12" increments

Note: 18" white only cords available upon request

## MOUNTING REQUIREMENTS

<b>INSIDE MOUNT</b>	
Standard, Cordless, Retractable Cord, Simplicity Motorization, & PowerWand	
Minimum casement depth*	1"
Minimum casement depth*, fully recessed	3-3/8"
Minimum rear fabric clearance	1/8"

<b>OUTSIDE MOUNT</b>	
Standard, Cordless, Retractable Cord, Simplicity Motorization, & PowerWand	
Minimum mounting surface height	1"
Recommended width overlap per side	3"
Minimum rear fabric clearance	1/8"

<b>END MOUNT</b>	
Standard, Retractable Cord, Simplicity Motorization & PowerWand	
Minimum mounting surface depth*	1-1/4"

\* Add 1/4" to minimum depth dimensions if optional back cover is used for inside or end mounts.

<b>INSIDE MOUNT - REMOTELIFT 2.0</b>	Battery Wand	Sat. Bat. Pack
Minimum casement depth*	2"	1-1/4"
Minimum casement depth*, fully recessed	4"	3-1/2"
Minimum rear fabric clearance	1/8"	1/8"

<b>OUTSIDE MOUNT - REMOTELIFT 2.0</b>	Battery Wand **	Sat. Bat. Pack
Minimum mounting surface height	1"	1"
Recommended width overlap per side	3"	3"
Minimum rear fabric clearance	1/8"	1/8"

<b>END MOUNT - REMOTELIFT 2.0</b>	Battery Wand	Sat. Bat. Pack
Minimum mounting surface depth*	2-1/8"	1-1/2"

\* For inside and end mounts an optional back cover and back cover bracket may be ordered. The back cover bracket attaches to the installation brackets.

\*\* Requires 3/4" spacers per installation bracket (included), due to the added clearance required for the battery wand.

## FINISHED DIMENSIONS

Dimensions apply to standard loop control, cordless lift, retractable cord and motorization

NOTE: WIDTH AND HEIGHT MAY VARY ± 1/8"

<b>INSIDE MOUNT – Standard Deductions</b>	
Headrail unit	1/8" less than ordered width
Fabric width	1" less than ordered width
Fabric width - Cordless Lift	3/4" less than ordered width
Shading height	1/8" less than ordered height

<b>OUTSIDE MOUNT – Standard Deductions</b>	
Headrail unit	ordered width
Fabric width	3/4" less than ordered width
Fabric width - Cordless Lift	5/8" less than ordered width
Shading height	1/8" less than ordered height

<b>END MOUNT – Standard Deductions</b> (not available with Cordless Lift)	
Headrail unit	11/16" less than ordered width
Fabric width	1-1/2" less than ordered width
Shading height	1/8" less than ordered height

<b>TWO-ON-ONE HEADRAIL</b> (not available with Cordless Lift, RemoteLift 2.0, Simplicity Rechargeable, or PowerWand)	
Fabric width	1 1/4" less than ordered width
Gap between fabric panels	3/8"

<b>FABRIC GAP – End Gap to Fabric (Gaps On Each Side)</b>	
Control Side	5/8"
Idle Side	3/8"
Both Sides - Cordless Lift	3/8"

## OPTIONS

### RETRACTABLE CORD

Raise, lower and tilt shadings with one retractable cord. The cord length remains constant when shading is raised or lowered, making it ideal in homes with children or pets. Cord length will be 40% of the shading height and may be shortened for enhanced child safety.

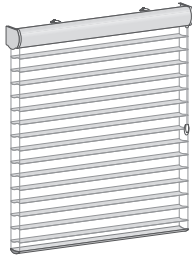

### TWO-ON-ONE HEADRAIL

Cover patio doors and other large expanses by placing two independently operated shades side-by-side on the same headrail. Note there will be a 3/8" light gap between the two shades, see minimum/maximum requirements under product specification section.

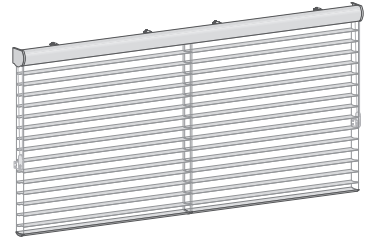

### CORDLESS LIFT

Raise, lower, and tilt shadings with cordless lift. A great choice for homes with children and pets, the lift, lower, and tilt mechanism are all controlled by the clear plastic handle attached to the bottomrail.



With your thumb on the front of the handle and fingers on the back, gently pull down to lower the shading. The hinged handle elegantly retracts when released. Continue pulling on the handle to lower the shadings and open the vanes.

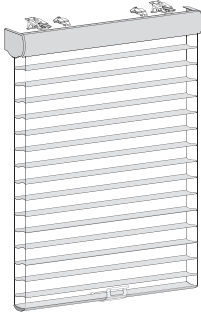

To close the vanes and raise the shades, gently pull down on the handle (about 1") and release. The vanes will close and then the shading will retract into the headrail.

### TILT ONLY SHADING

Ideal for sidelights or narrow windows.

- Shading cannot be raised, it can only be tilted open or closed.
- Hold down brackets are used to secure the bottomrail.

### FABRIC-COVERED HEADRAIL

Features a coordinating fabric wrapped onto the headrail to provide a soft fabric look from top to bottom. (See surcharge on pricing pages)



# OPTIONS

## OPTIONAL BACK COVER (INSIDE MOUNT)

Used with inside mounts to conceal the open rear side of the headrail for a more pleasing exterior look. Use of the back cover adds 1/4" to minimum inside mounting depths.

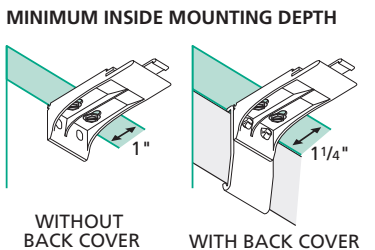

The back cover is secured in place by a back cover bracket attached to the installation bracket.

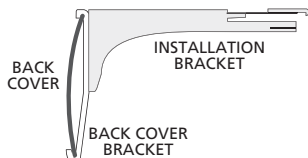

## BACK COVER BRACKET

When a back cover is used, attach back cover brackets to the installation brackets before mounting them. Remove the tab from the top of the back cover brackets and both tabs at the rear of the installation brackets.

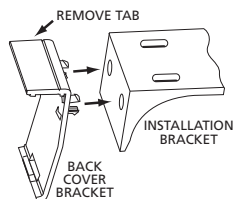

After mounting the installation brackets, install the back cover.

## ADJACENT SHADINGS

To span wide window openings, window shadings may be installed adjacently, so their headrails abut. The gap between the fabric panels of the adjacent shadings varies according to the control placement, as shown in the table below.

CONTROL PLACEMENT	
Adjacent (Abutting) Window Shadings	
Left/Right Shadings	Center Gap
Right/Right Controls	3/4"
Left/Left Controls	3/4"
Right/Left Controls	1-1/16"
Left/Right Controls	1/2"
Window shadings are not recommended for bay windows or butt-and-pass applications.	

## OPTIONAL DUST COVER (OUTSIDE MOUNT)

Shields the fabric and internal headrail components from dirt, dust, and other contaminants.

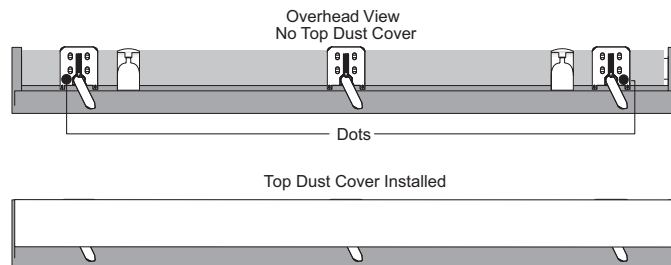

## SIDE-BY-SIDE VANE ALIGNMENT

When window shadings are installed side by side, vane alignment can be guaranteed within 1/4" only if:

- Shadings are ordered at the same time and in the identical style, color and height.
- Shadings that need to be aligned are specified on the order form (a note must be included in Special Instructions).
- Shadings exceeding combined width of 120" cannot be guaranteed

Note: Vane alignment cannot be guaranteed for Two-On-One Headrail and motorized shadings combined on the same order.

## ADDITIONAL NOTES

### SHADING ADJUSTMENT

Shadings should wind evenly and not skew to one side.

A balance weight on the bottomrail can easily be adjusted if the fabric winds unevenly on the roll when the window shading is raised. Uneven winding can cause damage to the edge of the fabric.

- If skewing does occur:
  - Ensure headrail was installed level; shim if necessary.
  - To release, insert a flat blade screwdriver into the weight lock and turn clockwise.
  - Adjust placement of weight in bottomrail, 1" at a time, toward side where fabric is gathering.
  - Secure the weight locks in position by turning them counter clockwise, after making the adjustment.
  - Raise shade, then lower, if necessary, adjust again.

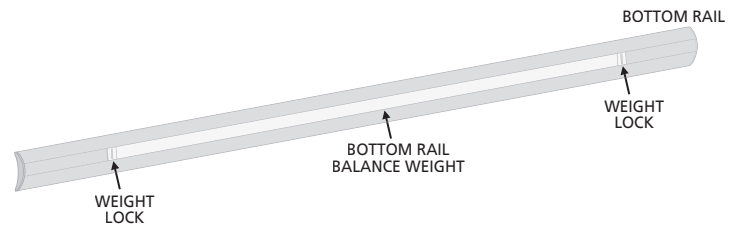

### SHADING INSTALLATION

To mount the shading, insert the top of the headrail into the brackets between the locking tab and the bracket flange. Push the headrail into the brackets until the locking tab clicks in place.

To remove the shading, lift the locking tab to release the headrail, rotate the headrail forward, and pull it straight out.

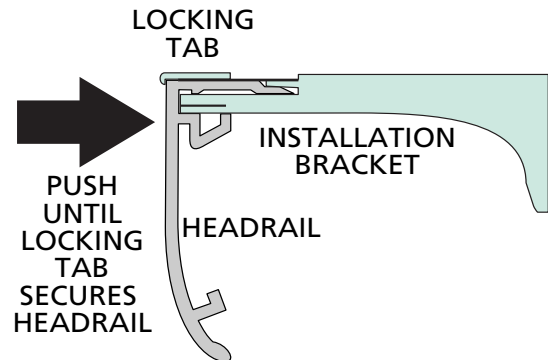

### MAGNETIC HOLD-DOWN BRACKETS

Magnetic hold-down brackets secure the bottom of the shading to prevent swaying. Available upon request. Standard on tilt-only shadings.

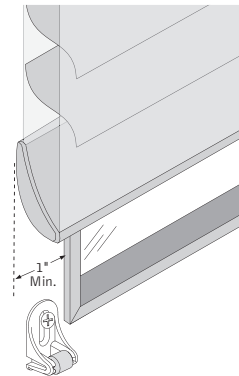

# SIMPLICITY RECHARGEABLE MOTORIZATION: OVERVIEW

## Simplicity Rechargeable

- The Rechargeable Simplicity motor program features an integrated rechargeable lithium ion battery in the motor casing and is fully concealed by the inner tube.
- Rechargeable battery is included with the motor. The average battery charge will last 6-12 months based on an average sized shade raised and lowered once per day. The life of the battery charge will vary based on the type of window covering selected, the size and weight of the window covering and the number of times the shade is operated on a daily basis. The battery can be recharged up to 500 times. It takes approximately 5 hours to recharge the motor when fully depleted. (Charging port available on the right side only)

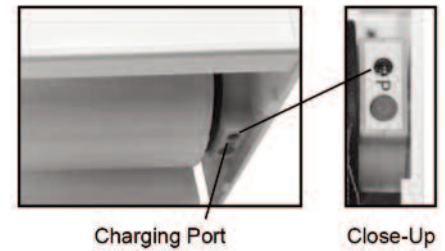

## Battery Charger

- An 8.4 Volt charger requires a standard power outlet to recharge the battery. The charger must be specified when ordering Simplicity Rechargeable Motorized shade option. The charger plugs into the charging port of the motor. The charger is black and comes with a 156" wire. The dimensions are 1" wide x 2-1/2" length x 1-3/4" deep. Sold separately.



## Solar Panel Recharge Option

- Plugs in to any Simplicity Rechargeable motorized shading (does not work with PowerWand). Provides constant trickle charge to 7.4v Li-ION Rechargeable battery packs. Does not require direct sunlight, but performs best in regular direct sunlight applications. Will prolong the life of the charge of the 7.4v rechargeable battery packs, and in some applications will maintain charge indefinitely.
- Life of charge is subject to application variables such as size and weight of shade, frequency of use, amount of direct sunlight exposure, etc.



Dimensions of panel  
18½" x 1½"

## 5 Channel Remote

- The remote can operate up to five shadings simultaneously, individually or in groups. Remotes and holders are available in white or black. The remote comes with a holder which can be mounted to a wall for easy storage. The range of the remote is approximately 80 feet.



White  
(Part #CS5138W)

Black  
(Part #CS5138)

Please Note:

- Not all motors run at the same rate of speed.
- Simplicity motors have a "Favorites" position setting. To set a "Favorites" position, follow instructions provided in the installation instructions.

---

# POWERWAND MOTORIZATION: OVERVIEW

---

## PowerWand™ Motorization

- Shadings can be fabricated with the PowerWand Rechargeable Push Button Control option. The PowerWand Rechargeable option is an easy, cord free motorized operation for the budget savvy homeowner. PowerWand Rechargeable uses Simplicity motors and components.

## PowerWand Rechargeable Shades Operation

- Press the up or down button on the pendant to raise or lower the shading to your desired position. No programming is required with PowerWand as upper and lower limits are set at the factory. If desired, upper and lower limits can be adjusted in the field.
- Please refer to the installation instructions for instructions on resetting the upper and lower limits and setting a favorites position can be programmed on-site.

## PowerWand Appearance

- The PowerWand Rechargeable wand and pendant is attached to the head rail and requires no additional mounting.
- The wand and pendant hangs down the front of the shades from the head rail.
- Pendant is 2-1/2" long.
- The pendant does not need to be mounted to the wall to operate the shade.



## PowerWand Options

- Wand is available in Black or White (there is no default).
- Wand is available in 1 foot increments from 1 to 5 feet (there is no default).
- Wand is available on the right side of the shade ONLY.



White



Black Shown with Plug-In Charger

## PowerWand Battery Life

- The battery life will vary based on the type of window covering selected, the size and weight of the window covering and the number of times you operate the blind on a daily basis.

## Battery Charger

- 8.4 Volt charger requires a standard power outlet to recharge the battery. The charger must be specified when ordering the PowerWand motorization option. The charger plugs into the charger port on the side of the pendant. The charger is black and comes with a 156" wire. The dimensions are 1" wide x 2-1/2" length x 1-3/4" deep.



# REMOTELIFT™ 2.0 PRODUCT CONFIGURATION SPECIFICATIONS

RemoteLift 2.0 combines IR and RF wireless signals to control your window shadings. By using both line-of-sight (infrared technology) and "out-of-sight" (radio frequency technology), your customers achieve more operating flexibility. RemoteLift 2.0 operates one window at a time or a group of windows, even in multiple rooms.

- Quieter, more robust motor for raising, lowering and tilting shadings
- Ideal option for hard-to-reach windows behind furniture, above counters, in high foyers, etc.
- Enhanced safety in homes with children and pets
- State-of-the-art convenience; multiple options allow even further customization of window shadings
- Battery-powered system is easy to install and requires no additional wiring



## REMOTELIFT 2.0 SYSTEM OPTIONS

### BATTERY WAND

Battery wands are the standard power source whether inside (IB), outside (OB) or end (EB) mount, if applicable. Battery wands are mounted on the rear of the headrail. The redesigned battery wand will allow for batteries to be changed without removing the window covering from the window.

- 12 AA 1.5V alkaline batteries.
- Battery life exceeds one year, depending on usage.
- Replace batteries when the window covering(s) begin to operate slowly.



18V Battery Wand

### SATELLITE BATTERY PACK

The satellite battery pack is an optional power source. The battery pack connects to the same side of the headrail where the receiver eye or satellite eye is located. The satellite battery pack is the best choice when the window covering is mounted in a high window, restricting access to a battery wand.

- 18V satellite battery pack:
  - Available in 15", 4', 10' and 20' wire lengths.
  - 12 AA 1.5V alkaline batteries.
- Battery life is approximately one year, depending on usage.
- Replace batteries when the window covering(s) begin to operate slowly.
- Mounting options: top of headrail, next to molding or under the sill.
- Satellite battery pack cover can be painted.



18V Satellite Battery Pack

### DC POWER SUPPLY

The DC power supply is an optional power source. The DC power supply plugs into any standard household outlet.

- 18V DC power supply:
  - Available in 15", 4', 10' and 20' wire lengths.
- Eliminates need to change batteries.



18V DC Power Supply

## DAISY CHAIN

The optional Daisy Chain Adapter allows up to 3 shades to run off of one DC power supply. You must specify the cable wire length when order is placed.

Note: Keep in mind which side the sensor eye is positioned on each side when determining daisy-chain length.



Daisy-Chain Adapter/Connector



# STANDARD SHADING OPERATION

## STANDARD SHADING OPERATION

Shadings are operated using a continuous cord loop. As shown in the illustration below, from the fully raised position [1] pulling down on the rear half of the cord loop lowers the shading [2, 3]. After it is fully lowered, continuing to pull down on the cord pivots the bottomrail and opens the fabric vanes [4]. When the vanes are fully open [5], limit stops in the headrail prevent further movement in that direction.

With the fabric vanes fully open, pulling down on the front half of the cord loop first closes the vanes [6, 7] and then raises the window shading [8]. When it is fully raised [1], limit stops again halt shading movement, preventing the bottomrail from being retracted too far into the headrail.

## Light Control

With the shading in the fully lowered position, the continuous cord loop is used to adjust the fabric vanes from open to closed, and anywhere in between. Light control is at your customer's fingertips. (Note: The degree of maximum vane closure varies slightly from the top to the bottom of the shading.)

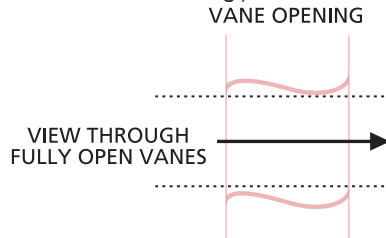

## Vane Opening

Vane opening is the amount of unobstructed visibility between fully open vanes when looking through the shading at eye level. Vane opening for shadings is 1" to 1-1/2" depending on vane size and opacity.

## Vane Closure

When the vanes of a window shading are closed, they overlap each other, blocking the view. However, the vanes do not contact each other along the full length of the shading – they do not form a perfect seal against light leakage. This is most visible toward the bottom of the shading.

Vane closure is measured as the distance between the front and rear fabric facings 6" up from the lowest point of the bottomrail, with the shading fully lowered and the vanes closed, as illustrated here. Vane closure is 5/8" for shadings under 96" in height and 7/8" for shadings over 96" in height.

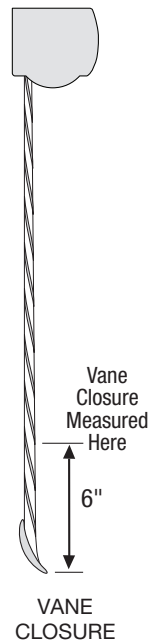

**PLEASE NOTE:** Cord tensioner MUST be mounted to window casement or wall in order for the shade to operate.

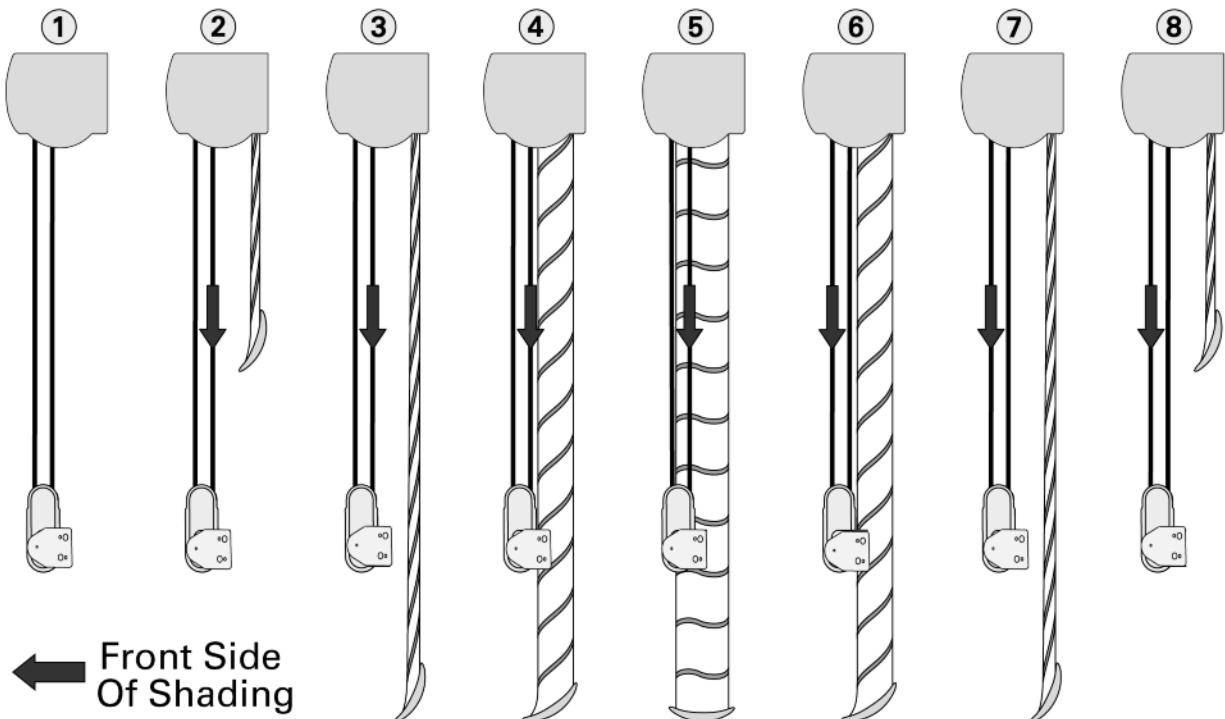

# OPERATION

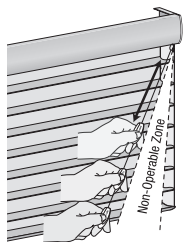

## RETRACTABLE CORD

### To Lower the Shading

To lower shading and open vanes, pull cord toward the center and down in long even strokes. Note: Allow cord to fully retract between each stroke.

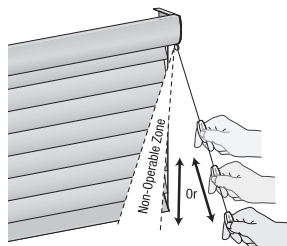

### To Close and Raise the Shading

To close vanes and raise shading, pull cord straight down or down and slightly out using long even strokes.

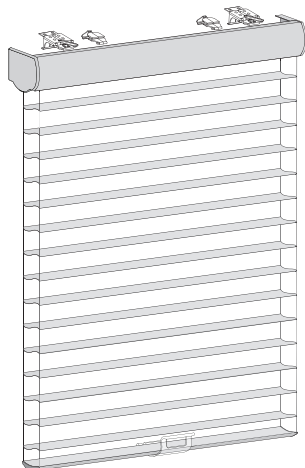

## CORDLESS LIFT

Raise, lower, and tilt shadings with cordless lift. A great choice for homes with children and pets, the lift, lower, and tilt mechanism are all controlled by the clear plastic handle attached to the bottomrail.

With your thumb on the front of the handle and fingers on the back, gently pull down to lower the shading. The hinged handle elegantly retracts when released. Continue pulling on the handle to lower the shadings and open the vanes.

To close the vanes and raise the shades, gently pull down on the handle (about 1") and release. The vanes will close and then the shading will retract into the headrail.



# PRODUCT COMPONENTS – STANDARD

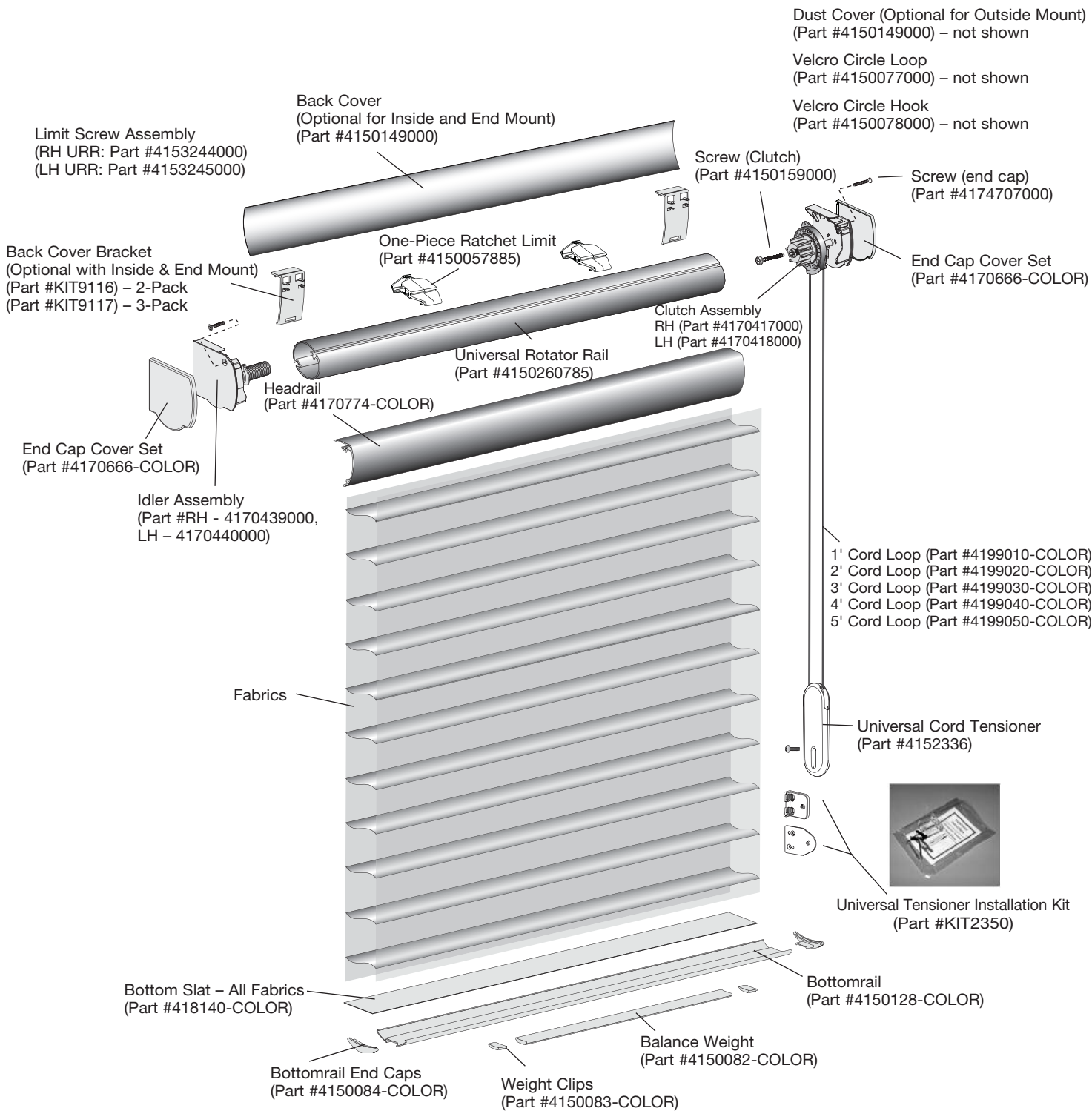

MAGNETIC HOLD-DOWN  
(PART #KIT9108)

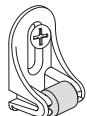

INSTALLATION  
BRACKET PAIR  
(PART #KIT9109)

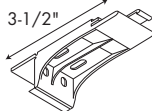

BRACKETS-3  
(PART #KIT9110)

BACK COVER  
BRACKET  
(Part #KIT9116) – 2-Pack  
(Part #KIT9117) – 3-Pack

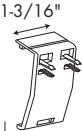

INSIDE MOUNT ONLY  
(OPTIONAL)

BACK COVER  
(PART #4150149000)

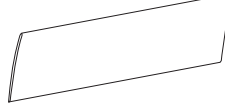

1/2" SPACER BLOCK  
(PART #KIT2011) – 2 PACK  
(PART #KIT2012) – 3 PACK



EXTENSION  
BRACKET  
(Part #KIT2013) – 2-Pack  
(Part #KIT2014) – 3-Pack

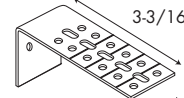

OUTSIDE MOUNT ONLY  
(OPTIONAL)

# PRODUCT COMPONENTS - RETRACTABLE CORD

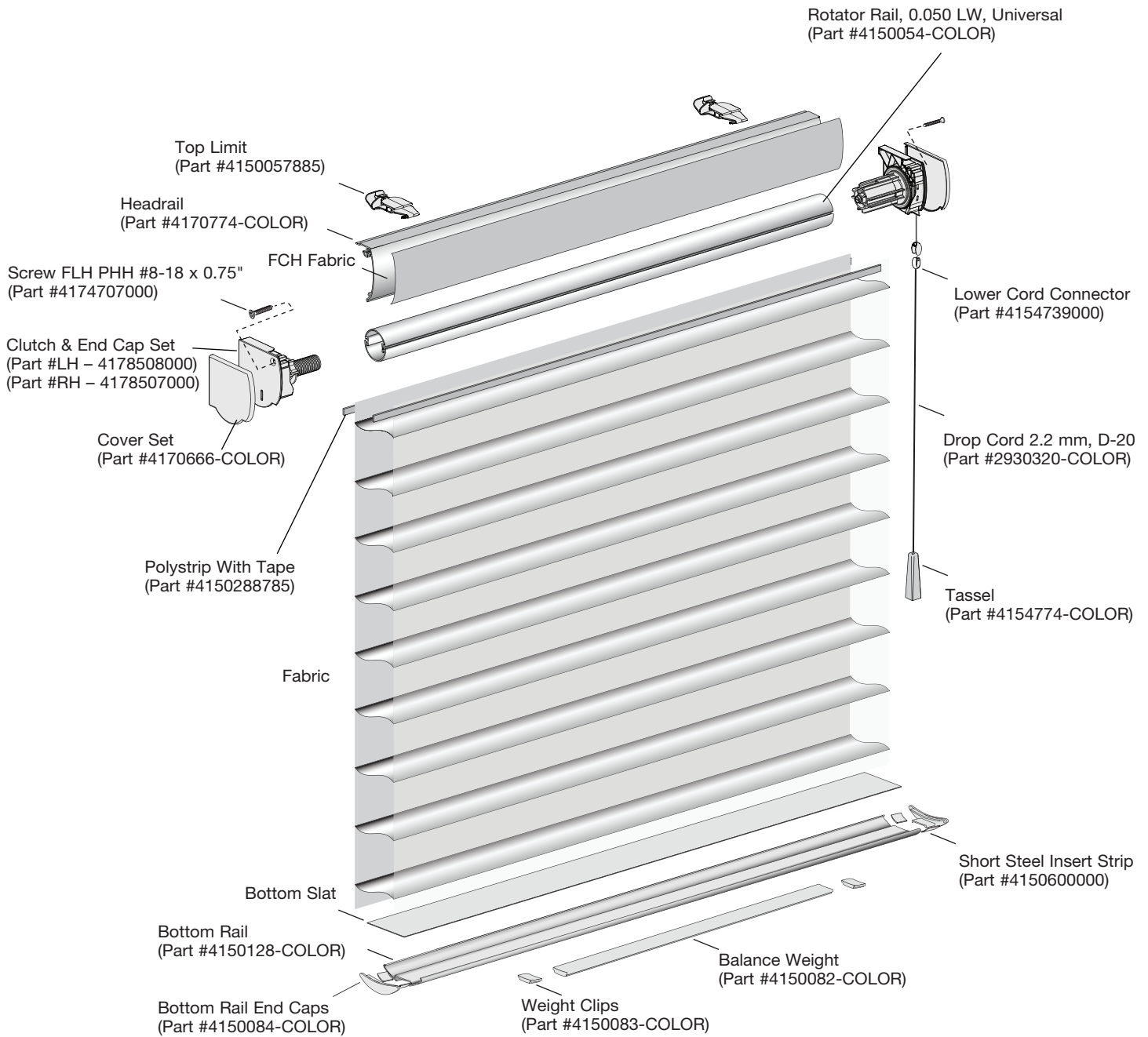

# PRODUCT COMPONENTS – CORDLESS LIFT

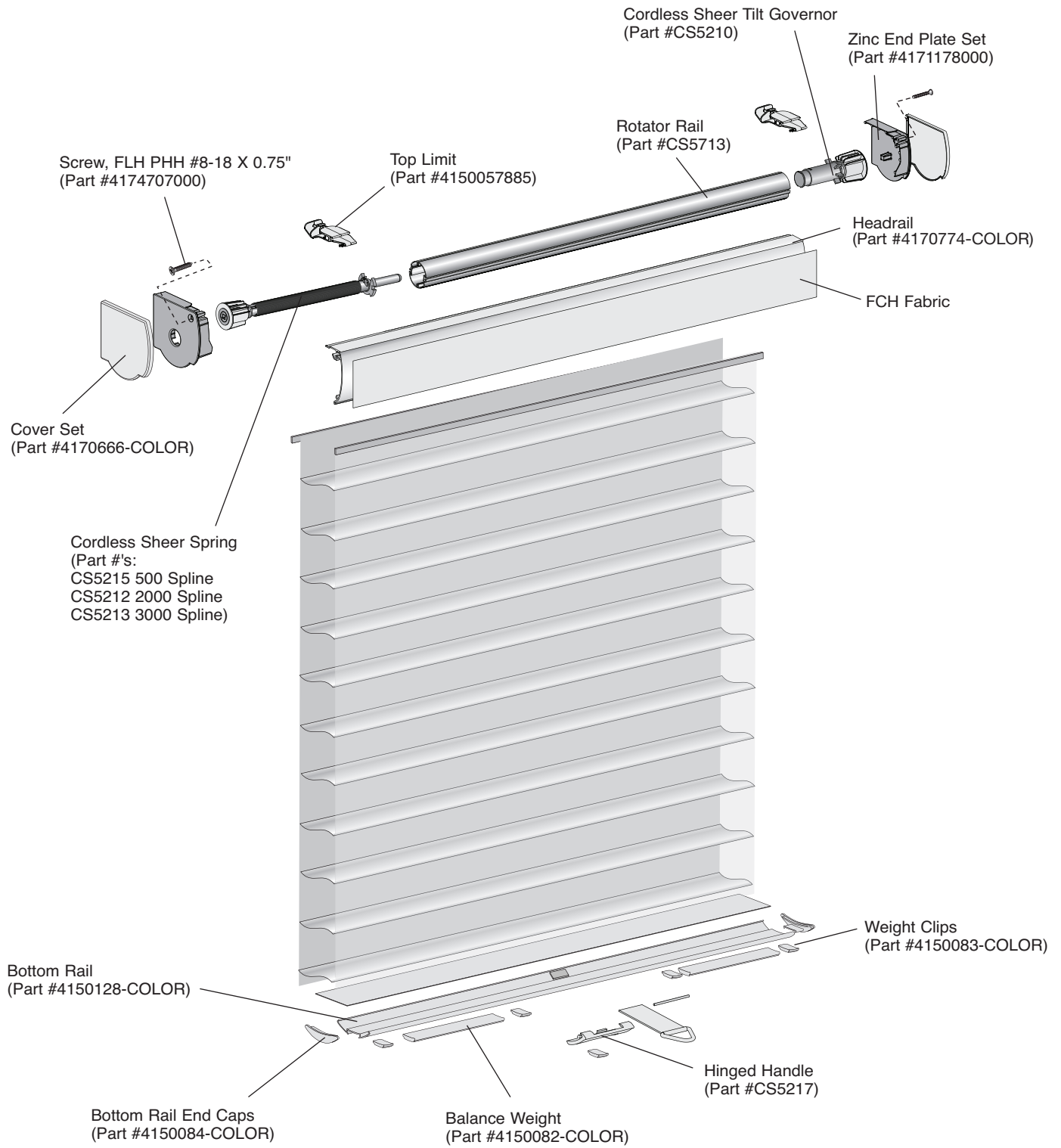

# PRODUCT COMPONENTS – SIMPLICITY RECHARGEABLE MOTORIZATION

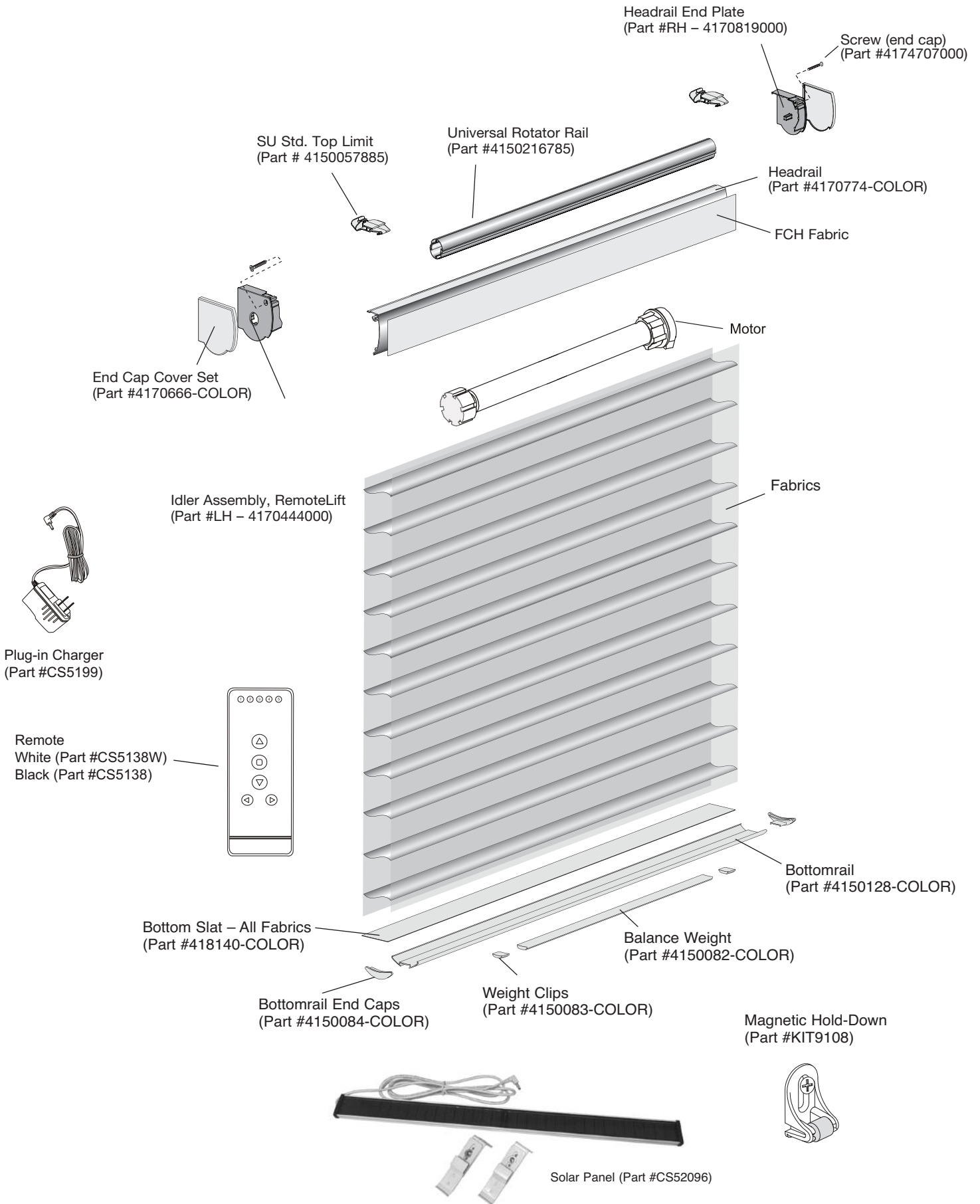

# PRODUCT COMPONENTS – POWERWAND MOTORIZATION

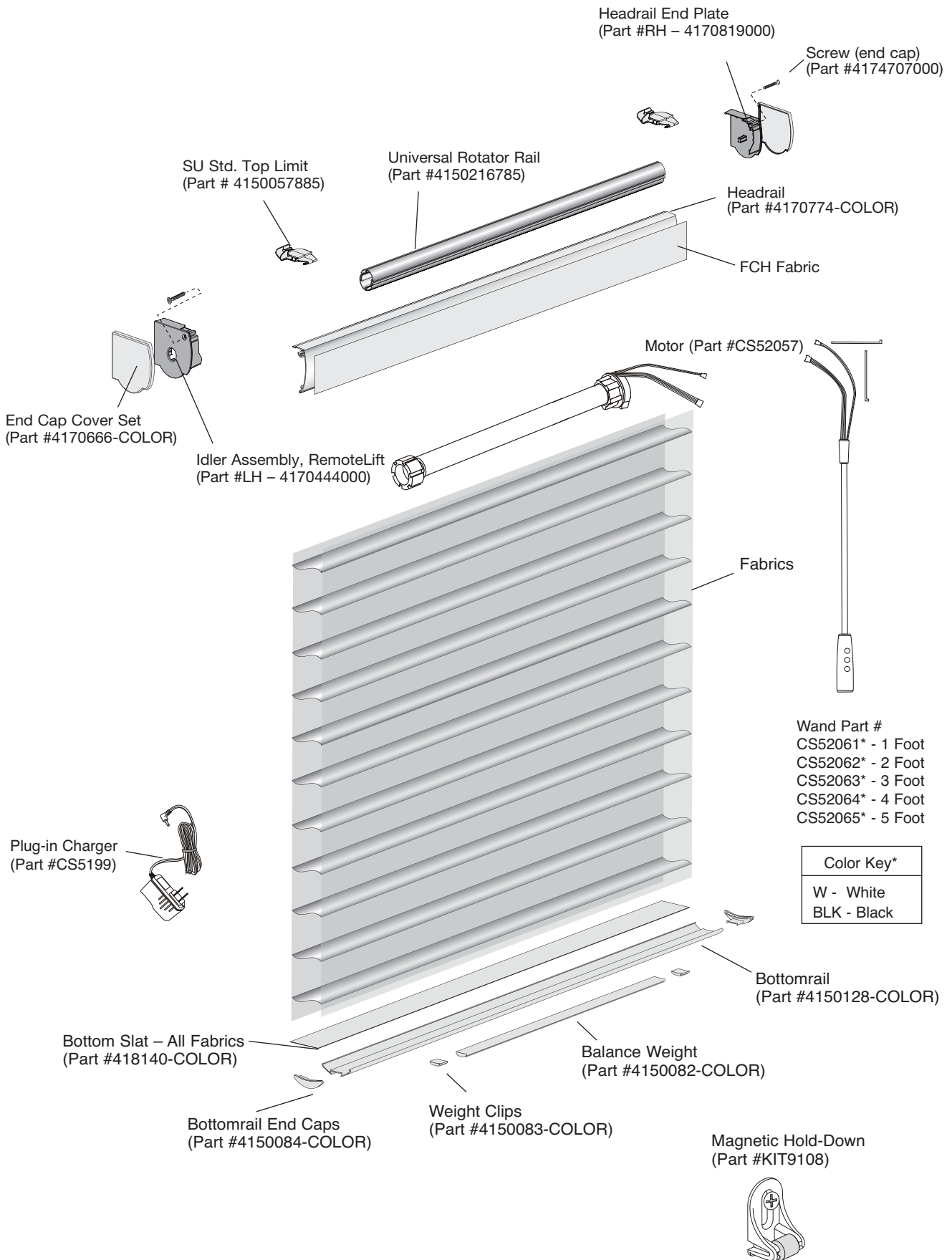

# PRODUCT COMPONENTS – REMOTELIFT™ 2.0

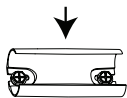
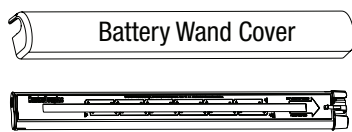
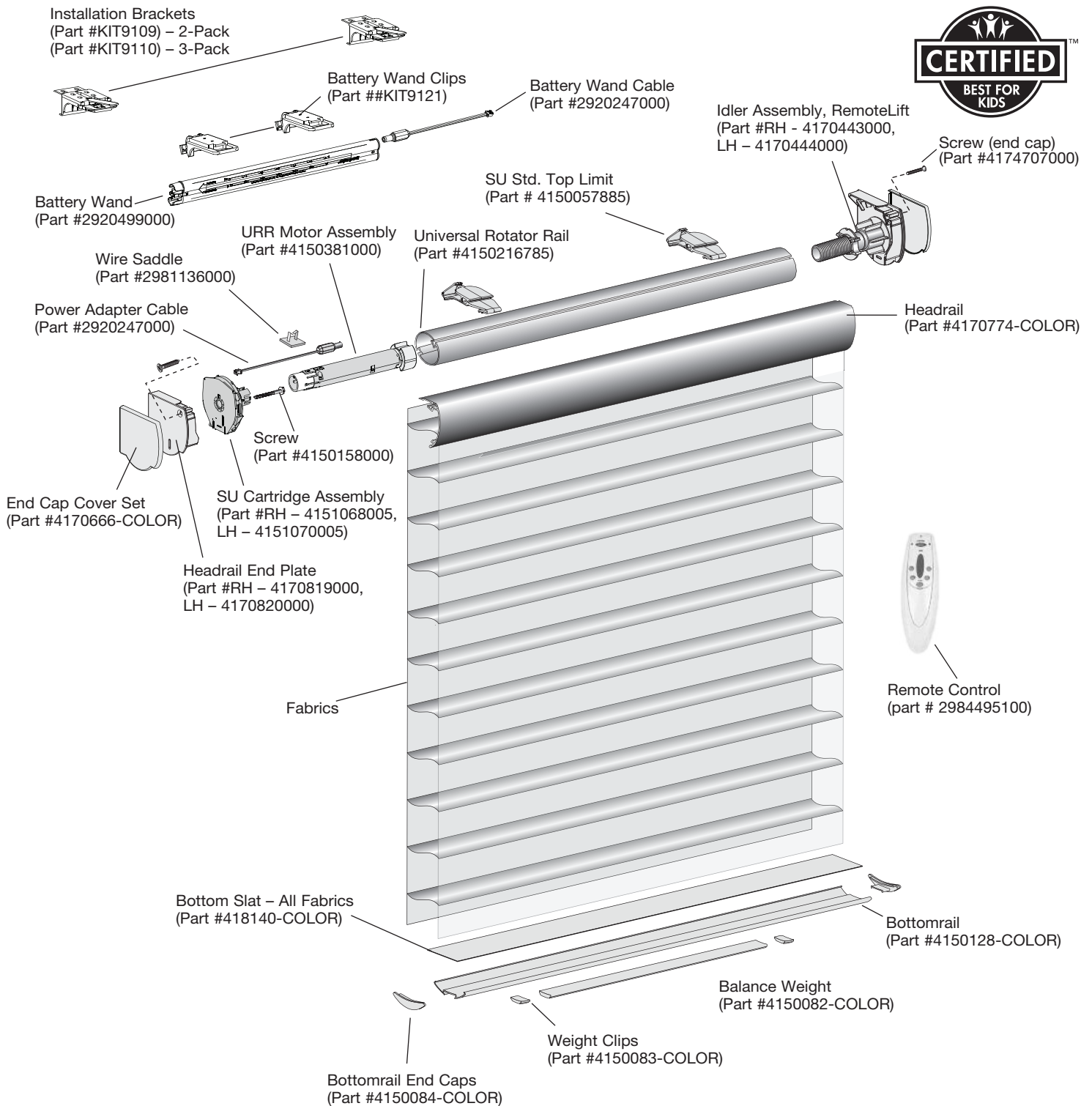

Satellite Battery Pack (Part #KIT2520) – Kit includes wand cover, mounting clip & installation screws.

Note: Battery Wand (#2920499000) & 12 AA Batteries (#KIT2529) are automatically included in original RL2.0 orders, but are also available separately as parts orders.

